

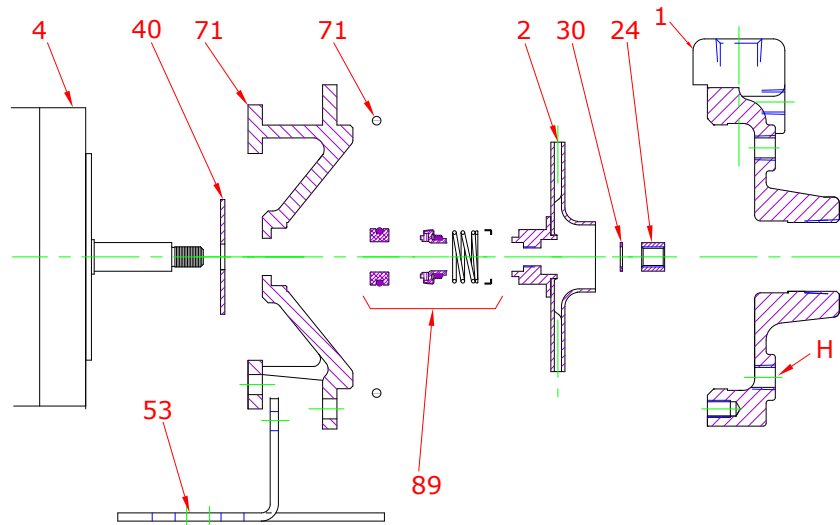

**Parts**



Key No.	Part Name	Part Number	
1	Case 11/13, Iron, 1.25 X 1.00 NPT Brass plugs	137.002.664X	
2	Impeller 11/12, Stainless, 3.50 Dia 7/16" Thrd, Encl	131.000.763R	
	Impeller 11/12, Stainless, 3.75 Dia 7/16" Thrd, Encl	131.000.763P	
	Impeller 11/12, Stainless, 4.00 Dia 7/16" Thrd, Encl	131.000.763J	
	Impeller 11/12, Stainless, 4.25 Dia 7/16" Thrd, Encl	131.000.763F	
	Impeller 11/12, Stainless, 4.50 Dia 7/16" Thrd, Encl	131.000.763E	
	Impeller 11/12, Stainless, 4.75 Dia 7/16" Thrd, Encl	131.000.763	
	Impeller 11/12, Stainless, 4.87 Dia 7/16" Thrd, Encl	131.000.763D	
	Impeller 11/12, Stainless, 5.00 Dia 7/16" Thrd, Encl	131.000.763C	
	Impeller 11/12, Stainless, 5.13 Dia 7/16" Thrd, Encl	131.000.763L	
	Impeller 11/12, Stainless, 5.25 Dia 7/16" Thrd, Encl	131.000.763B	
	Impeller 11/12, Stainless, 5.38 Dia 7/16" Thrd, Encl	131.000.763G	
	Impeller 11/12, Stainless, 5.50 Dia 7/16" Thrd, Encl	131.000.763H	
	Impeller 11/12, Stainless, 5.62 Dia 7/16" Thrd, Encl	131.000.763A	
4	Motor chart, J56 3.5" Rigid Base	See Chart	
	Motor chart, J56 Round Body	See Chart	
24*+	Nut, Stainless	105.000.465	
30*+	D Washer, Stainless	104.000.168	
40*	Flinger, Neoprene	104.000.171	
53	Base, Steel	119.000.231A	
71	Adapter, Iron, J56, 5/8" Seal, with Brass plug	132.000.337X	
73*	Gasket, Case, Buna	116.000.146	
89*	Seal, 5/8", Type 21, EPDM-CARB/CM, With retainer	101.000.327	
	Seal, 5/8", Type 21, EPDM-CARB/SIL, With retainer	101.000.173	
	Seal, 5/8", Type 21, EPDM-SIL/SIL, With retainer	101.000.236	
	Seal, 5/8", Type 21, VN-CARB/CM, With retainer	101.000.103	
	Seal, 5/8", Type 21, VN-CARB/SIL, With retainer	101.000.120	
	Seal, 5/8", Type 21, VN-SIL/SIL, With retainer	101.000.239	
	Seal, 5/8", Type 6, BN-CARB/CM, No retainer	101.000.110	
KIT		<b>3 Phase:</b>	<b>1 Phase:</b>
	Repair Kit, 5/8" BN-CARB/CM Seal	118.000.340	118.000.340.1
	Repair Kit, 5/8" EPDM-CARB/CM Seal	118.000.340R	118.000.340R.1
	Repair Kit, 5/8" EPDM-CARB/SIL Seal	118.000.340C	118.000.340C.1
	Repair Kit, 5/8" EPDM-SIL/SIL Seal	118.000.340D	118.000.340D.1
	Repair Kit, 5/8" VN-CARB/CM Seal	118.000.340A	118.000.340A.1
	Repair Kit, 5/8" VN-CARB/SIL Seal	118.000.340B	118.000.340B.1
	Repair Kit, 5/8" VN-SIL/SIL Seal	118.000.340J	118.000.340J.1

\* Denotes components included in repair kit.  
+ Not required on 1/3 to 1-1/2 HP 1 phase motors.  
Use 3 phase kits on 2-3 HP 1 phase motors.

**Motor Charts**

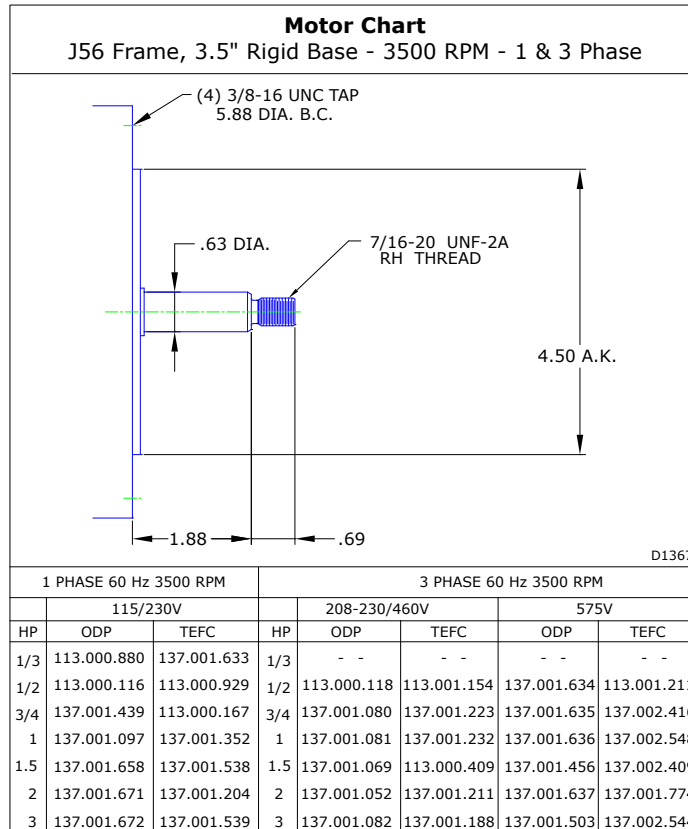
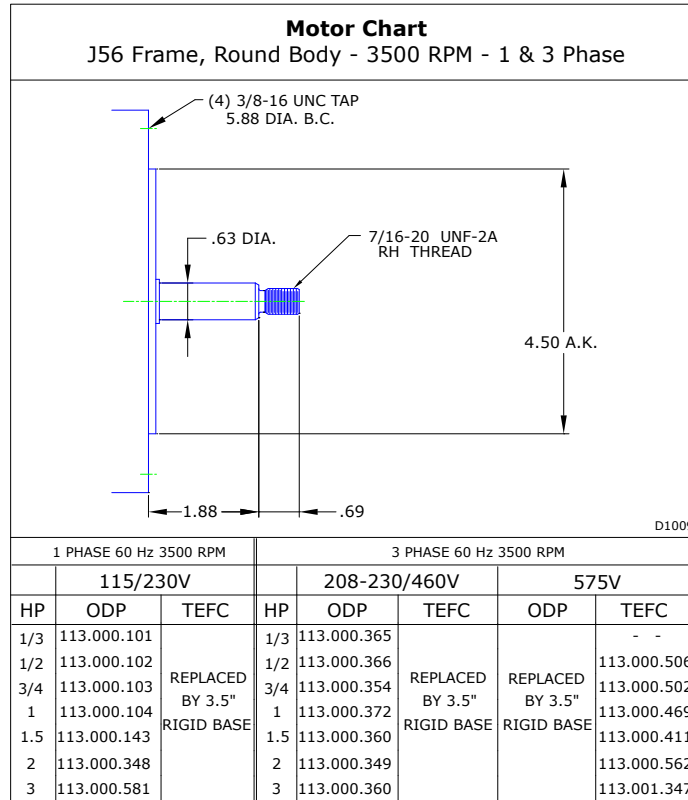

**Construction Options**

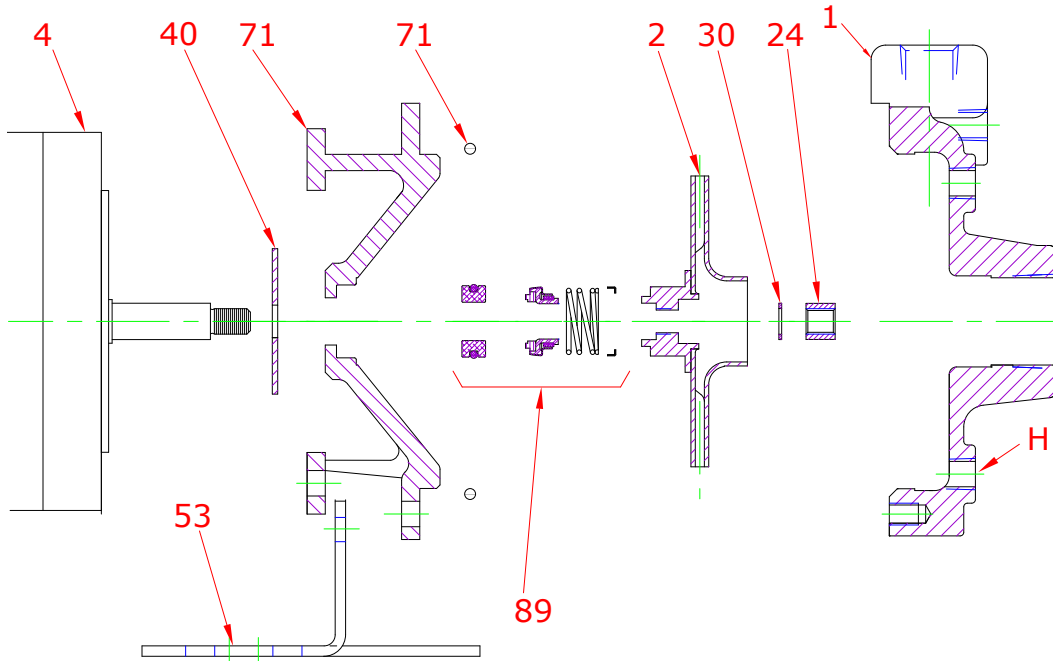

Construction Options			
Key	Part Name	Standard Fitted	All Iron
1	Case	Iron	Iron
2	Impeller	Stainless	Stainless
24	Impeller Locknut	Stainless	Stainless
30	D-Washer	Stainless	Stainless
40	Flinger	Neoprene	Neoprene
53	Base	Steel	Steel
71	Adapter	Iron	Iron
73	Gasket, Case	Buna	Buna
89	Mechanical Seal, Type 6 BN-CM	Standard	Standard
H	Plug, Drain	Brass	Plated Steel