

Pump 59 • Iron • JM Frame • 1750 RPM

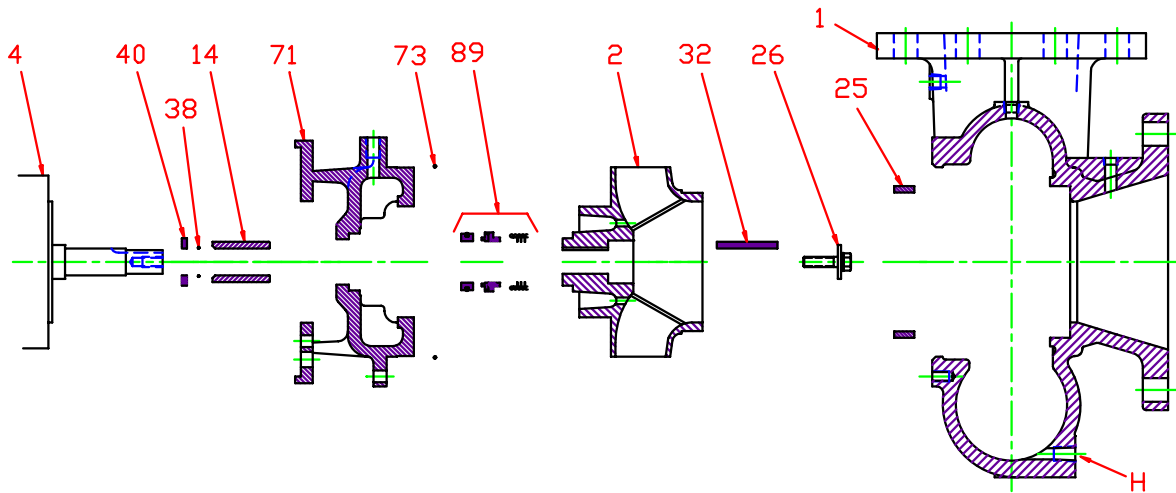

KEY NO.	PART NAME	PUMP NO. 59
1+	CASE, IRON, 6 x 5 FLG	137.000.563X
2	IMPELLER, 7/8" KEYED, ENCLOSED, SPECIFY DIAMETER:	
	IRON	137.000.564
	BRONZE	137.001.016
4	MOTOR, JM140/180	See Chart
	MOTOR, JM210	See Chart
14*	SHAFT SLEEVE, BRONZE	110.000.215
	SHAFT SLEEVE, STAINLESS	110.000.373
25	WEAR RING, BRONZE	137.000.565
26*	IMPELLER RETAINER, STAINLESS	118.000.609
32*	KEY, STAINLESS	102.000.256
38*	O-RING, SHAFT, BUNA	116.000.117
	O-RING, SHAFT, VITON	116.000.105
40*	FLINGER, STAINLESS	104.000.256
71	ADAPTER, IRON - JM140/180/210	137.000.566X
73*	GASKET, CASE, O-RING	116.000.184
89*	1½" SEALS:	
	BN-CARB/CM	101.000.168
	VN-CARB/CM	101.000.191
	VN-CARB/SIL	101.000.175
	VN-SIL/SIL	101.000.204
	EPDM-CARB/SIL	101.000.175B
	EPDM-SIL/SIL	101.000.204A
--	° REPAIR KITS:	
	BN-CARB/CM SEAL	118.000.529
	VN-CARB/CM SEAL (S)	118.000.529A
	VN-CARB/SIL SEAL	118.000.529B
	VN-SIL/SIL SEAL (S)	118.000.529C
	EPDM-CARB/SIL SEAL	118.000.529D
	EPDM-SIL/SIL SEAL	118.000.529E

* DENOTES COMPONENTS INCLUDED IN REPAIR KIT.
 + INCLUDES BRONZE WEAR RING. FOR STEEL WEAR RING, REPLACE SUFFIX "X" WITH "X1".
 ° ALL REPAIR KITS INCLUDE THE BRONZE SHAFT SLEEVE EXCEPT THE (S) INDICATED, WHICH IS STAINLESS WITH VITON SHAFT O-RING.

Pump 59 • Iron • JM Frame • 1750 RPM

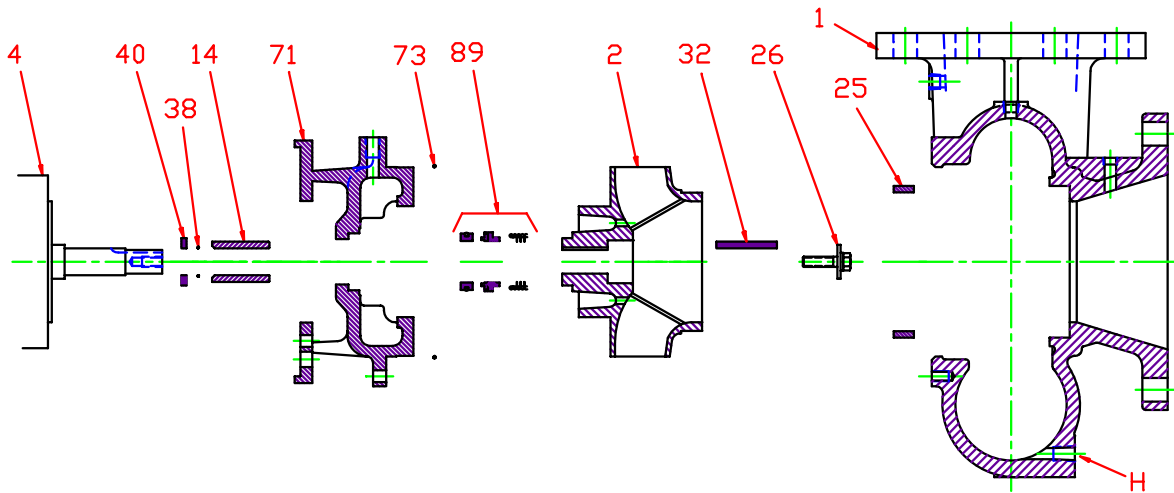

CONSTRUCTION OPTIONS

KEY	PART NAME	STANDARD FITTED	BRONZE FITTED	ALL IRON
1	Case	Iron	Iron	Iron
2	Impeller	Iron	Bronze	Iron
14	Shaft Sleeve	Bronze	Bronze	Stainless
25	Wear Ring	Bronze	Bronze	Steel
26	Impeller Retaining Assy	Stainless	Stainless	Stainless
32	Key	Stainless	Stainless	Stainless
38	Shaft O-Ring	BUNA	BUNA	BUNA
40	Flinger	Stainless	Stainless	Stainless
71	Adapter	Iron	Iron	Iron
73	Gasket, Case, O-Ring	BUNA	BUNA	BUNA
89	Mechanical Seal, Type 21 BN-CM	Standard	Standard	Standard
H	Plug, Drain	Brass	Brass	Plated Steel

E059JM180

J12

C0591750JM