

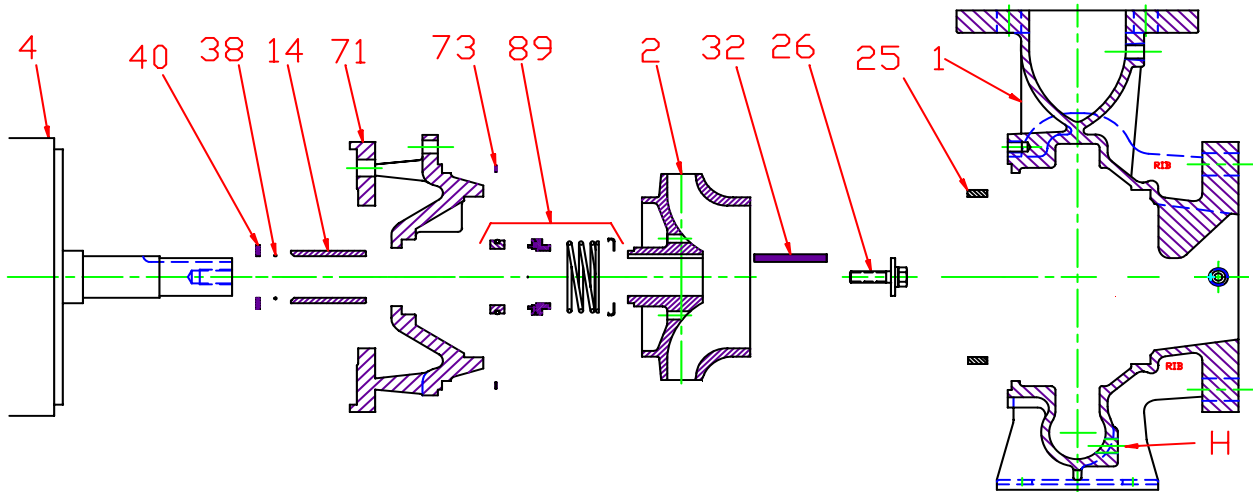

**Pump 57 • Iron • JM Frame • 3500 RPM**



KEY NO.	PART NAME	PUMP NO. 57	
		15 HP	20-40 HP
1+	CASE, IRON, 4 x 3 FLG	130.000.297X	
2	IMPELLER, ENCLOSED, SPECIFY DIAMETER: IRON BRONZE	7/8" KEYED	1 1/4" KEYED
		137.000.122 137.000.222	131.000.830 137.000.133
4	MOTOR, JM210 MOTOR, JM250 MOTOR, JM280/320	See Chart	--
		--	See Chart
		--	See Chart
14*	SHAFT SLEEVE, BRONZE SHAFT SLEEVE, STAINLESS	110.000.215 110.000.373	110.000.366 110.000.365
		25	WEAR RING, BRONZE WEAR RING, STEEL
26*	IMPELLER RETAINER, STAINLESS	118.000.163A	118.000.640
32*	KEY, STAINLESS	102.000.256	102.000.257
38*	O-RING, SHAFT, BUNA O-RING, SHAFT, VITON	116.000.117 116.000.105	116.000.218 116.000.218A
		40*	FLINGER, STAINLESS
71	ADAPTER, IRON - JM210	132.000.338X	--
	ADAPTER, IRON - JM250	--	132.000.316
	ADAPTER, IRON - JM280/320/360	--	132.000.317
73*	GASKET, CASE, FIBER	116.000.273	116.000.273
89*	SEALS:	1 1/2"	1 3/4"
	BN-CARB/CM	101.000.168	101.000.196
	VN-CARB/CM	101.000.191	101.000.216
	VN-CARB/SIL	101.000.175	101.000.221
	VN-SIL/SIL	101.000.204	101.000.231
	EPDM-CARB/SIL	101.000.175B	101.000.196B
	EPDM-SIL/SIL	101.000.204A	137.001.555
89A	SEAL RETAINER, STAINLESS	104.000.174	Included w/seal
--	° REPAIR KITS:		
	BN-CARB/CM SEAL	118.000.383	118.000.385
	VN-CARB/CM SEAL (S)	118.000.383A	118.000.385A
	VN-CARB/CM SEAL	118.000.383G	118.000.385D
	VN-CARB/SIL SEAL	118.000.383B	118.000.385B
	VN-SIL/SIL SEAL (S)	118.000.383E	118.000.385E
	EPDM-CARB/SIL SEAL	118.000.383C	118.000.385C
	EPDM-SIL/SIL SEAL	118.000.383F	118.000.385F

\* DENOTES COMPONENTS INCLUDED IN REPAIR KIT.

+ INCLUDES BRONZE WEAR RING. FOR STEEL WEAR RING, REPLACE SUFFIX "X" WITH "X1".

° ALL REPAIR KITS INCLUDE THE BRONZE SHAFT SLEEVE EXCEPT THE (S) INDICATED, WHICH IS STAINLESS WITH VITON SHAFT O-RING.

**Pump 57 • Iron • JM Frame • 3500 RPM**

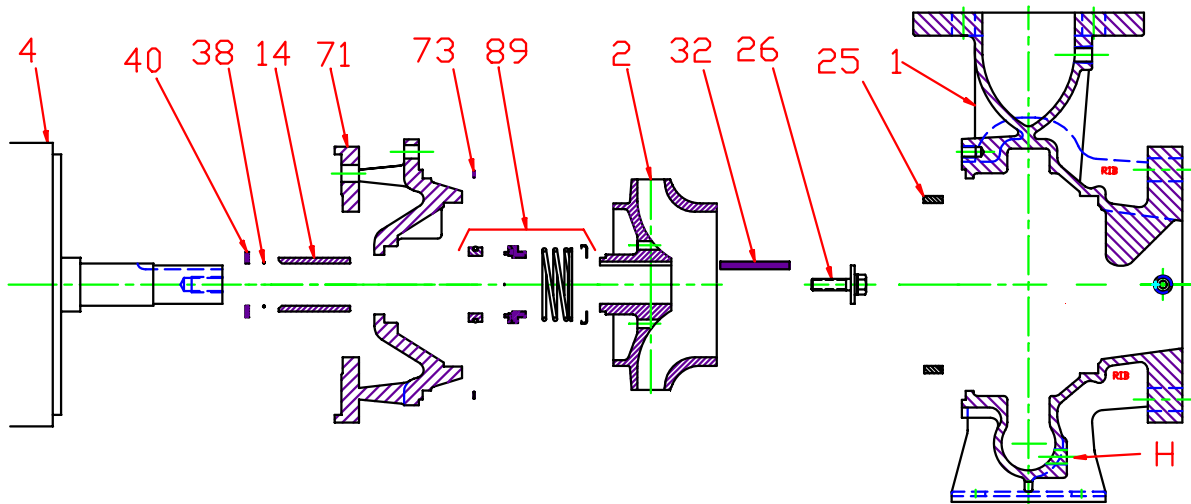

**CONSTRUCTION OPTIONS**

KEY	PART NAME	STANDARD FITTED	BRONZE FITTED	ALL IRON
1	Case	Iron	Iron	Iron
2	Impeller	Iron	Bronze	Iron
14	Shaft Sleeve	Bronze	Bronze	Stainless
25	Wear Ring	Bronze	Bronze	Steel
26	Impeller Retainer	Stainless	Stainless	Stainless
32	Key	Stainless	Stainless	Stainless
38	Shaft O-Ring	BUNA	BUNA	BUNA
40	Flinger	Stainless	Stainless	Stainless
71	Adapter	Iron	Iron	Iron
73	Gasket, Case	Fiber	Fiber	Fiber
89	Mechanical Seal, Type 21 BN-CM	Standard	Standard	Standard
89A*	Seal Retainer	Stainless	Stainless	Stainless
H	Plug, Drain	Brass	Brass	Plated Steel

\* Included with seal for 20-40HP

E057JM

E11

C0573500JM