

MOTOR DIMENSIONS

NEMA C56 FRAME 1750 RPM

HP	FRAME	ODP			TEFC		
		L	O	AB	L	O	AB
.50	C56	9.16	6.19	5.06	9.48	7.25	5.88
.75	C56	9.78	6.19	5.06	9.87	7.25	5.88

D019C56

DRAWING DEPICTS C56 ODP MOTOR

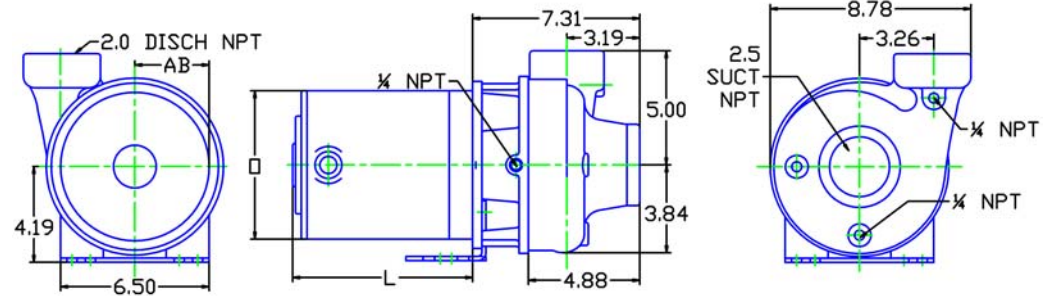

ALL DIMENSIONS IN INCHES.

DRAWING REPRESENTS APPROXIMATE PUMP DIMENSIONS. AUTOCAD DRAWING TO SCALE AVAILABLE FROM FACTORY.

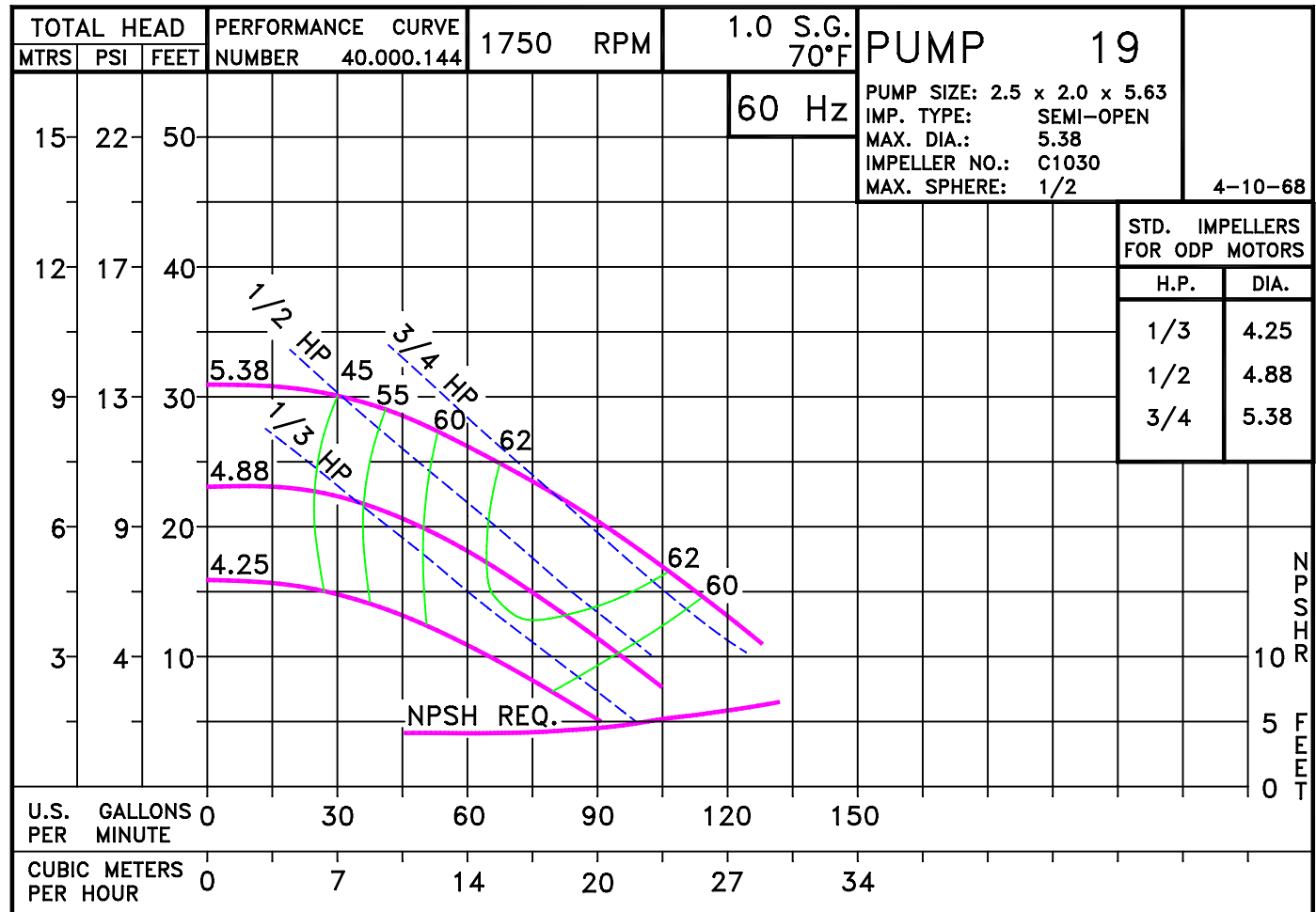
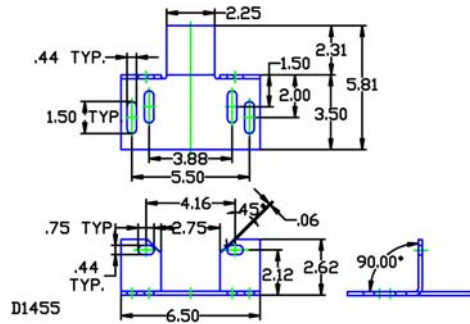

D1455
01705DP

D019C56
0191750

19

C56

0191750C56
81.001.117 K14

Pump 19 • Iron • C56 Frame • 1750 RPM

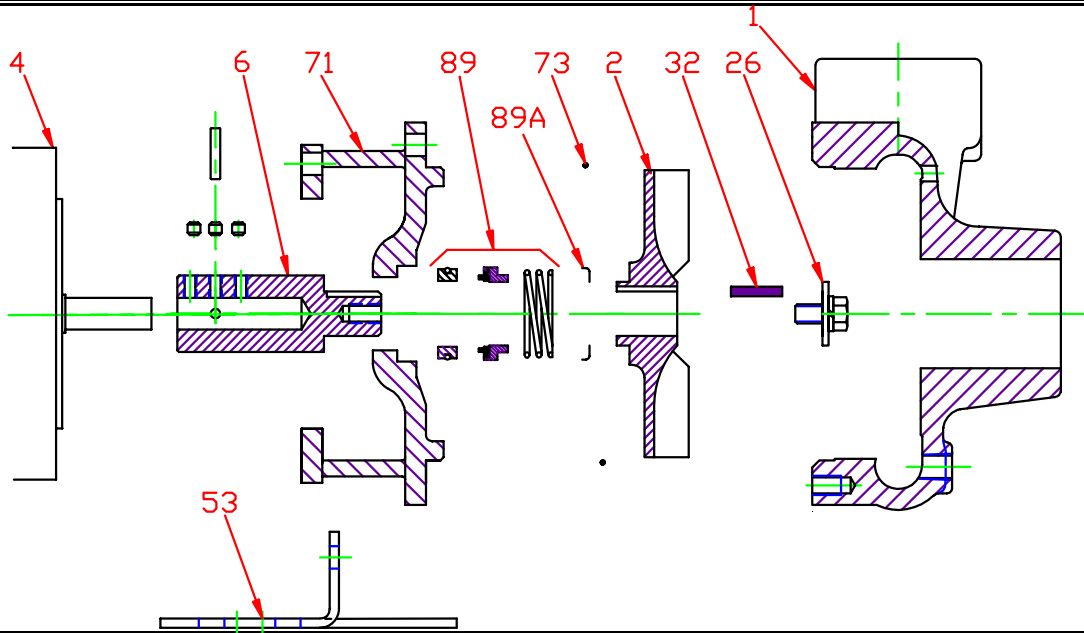

KEY NO.	PART NAME	PUMP NO. 19	
1	CASE, IRON, 2.5 x 2 NPT	130.000.166X	
2	IMPELLER, 7/8" KEYED, SEMI-OPEN, SPECIFY DIAMETER: IRON BRONZE	137.000.135 137.000.124	
4	MOTOR, C56	See Chart	
6+*	STUB SHAFT, BRONZE STUB SHAFT, STAINLESS	135.000.165X 135.000.174X	
26*	IMPELLER RETAINER, STAINLESS	118.000.111A	
32*	KEY, STAINLESS	102.000.102	
53	BASE, STEEL	119.000.237A	
71	ADAPTER, IRON	132.000.194X	
73*	GASKET, CASE, BUNA	116.000.146	
89*	1½" SEALS: BN-CARB/CM VN-CARB/CM VN-CARB/SIL VN-SIL/SIL EPDM-CARB/SIL EPDM-SIL/SIL	101.000.168 101.000.191 101.000.175 101.000.204 101.000.175B 101.000.204A	
	89A*	SEAL RETAINER, STAINLESS	104.000.175
	--	° REPAIR KITS: BN-CARB/CM SEAL VN-CARB/CM SEAL (S) VN-CARB/SIL SEAL VN-SIL/SIL SEAL (S) EPDM-CARB/SIL SEAL EPDM-SIL/SIL SEAL	118.000.381 118.000.381A 118.000.381B 118.000.381D 118.000.381C 118.000.381E
		* DENOTES COMPONENTS INCLUDED IN REPAIR KIT.	
		° ALL REPAIR KITS INCLUDE THE BRONZE STUB SHAFT EXCEPT THE (S) INDICATED, WHICH IS STAINLESS.	
		+ INCLUDES SET SCREWS AND PIN	

E019C56

F12

P0191750C56

Pump 19 • Iron • C56 Frame • 1750 RPM

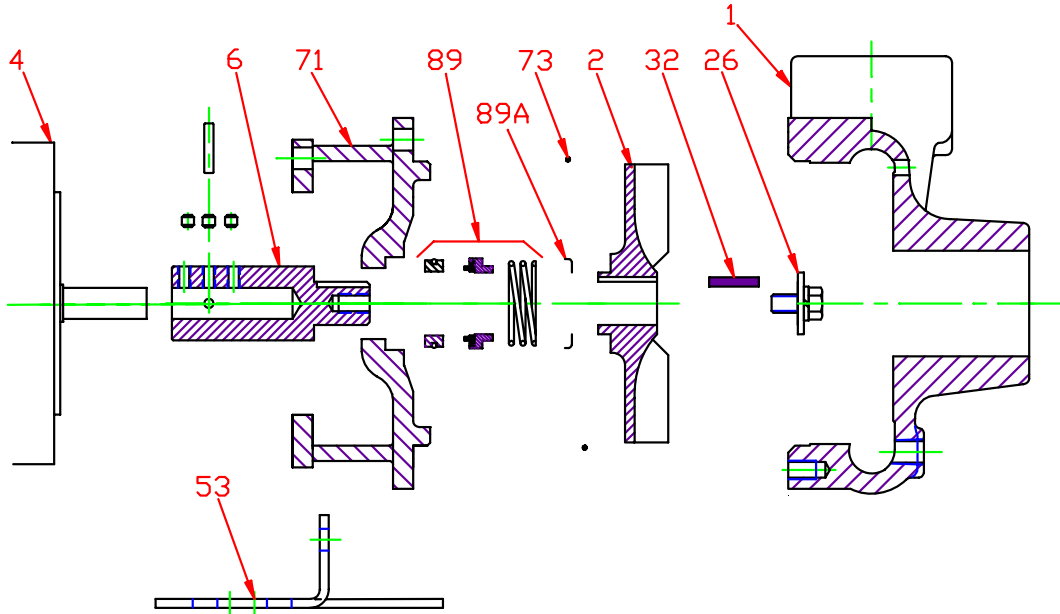

CONSTRUCTION OPTIONS

KEY	PART NAME	STANDARD FITTED	BRONZE FITTED	ALL IRON
1	Case	Iron	Iron	Iron
2	Impeller	Iron	Bronze	Iron
6	Stub Shaft	Bronze	Bronze	Stainless
26	Imp. Retaining Ass'y	Stainless	Stainless	Stainless
32	Key	Stainless	Stainless	Stainless
53	Base	Steel	Steel	Steel
71	Adapter	Iron	Iron	Iron
73	Gasket, Case	O-Ring BUNA	O-Ring BUNA	O-Ring
89	Mechanical Seal, Type 21 BN-CARB/CM	Standard	Standard	Standard
89A	Seal Spring Retainer	Stainless	Stainless	Stainless
H	Plug, Drain	Brass	Brass	Plated Steel

E019C56

F12

C0191750C56