

MOTOR DIMENSIONS

NEMA PREMIUM EFFICIENT JP FRAME 3 PHASE 3500 RPM

HP	Type	Frame	D	E	F	O	AB	BG	L	MH
25	ODP	JP256	6.25	5.00	5.00	12.00	9.49	9.78	7.91	0.53
30	ODP	JP284	6.97	5.50	4.75	13.07	11.37	9.53	11.53	0.53
40	ODP	JP286	6.97	5.50	5.50	13.07	11.37	10.28	10.78	0.53
50	ODP	JP324	8.00	6.25	5.25	15.59	13.20	10.53	10.90	0.66
20/25	TEFC	JP256	6.25	5.00	5.00	12.37	10.48	9.01	11.70	.53
30/40	TEFC	JP286	7.00	5.50	5.50	14.11	11.07	10.02	13.04	.53
50	TEFC	JP326	8.00	6.25	6.00	15.93	12.58	11.00	14.60	.66

D103JP284 DRAWING DEPICTS 284JP 30HP ODP MOTOR

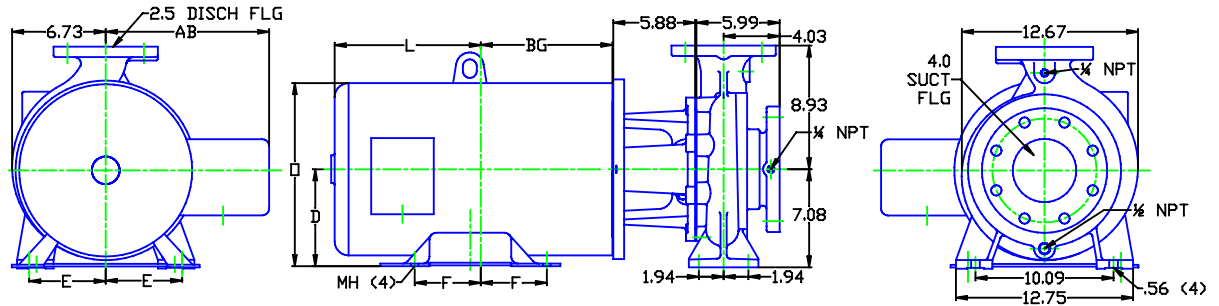

ALL DIMENSIONS IN INCHES.

DRAWING REPRESENTS APPROXIMATE PUMP DIMENSIONS. AUTOCAD DRAWING TO SCALE AVAILABLE FROM FACTORY.

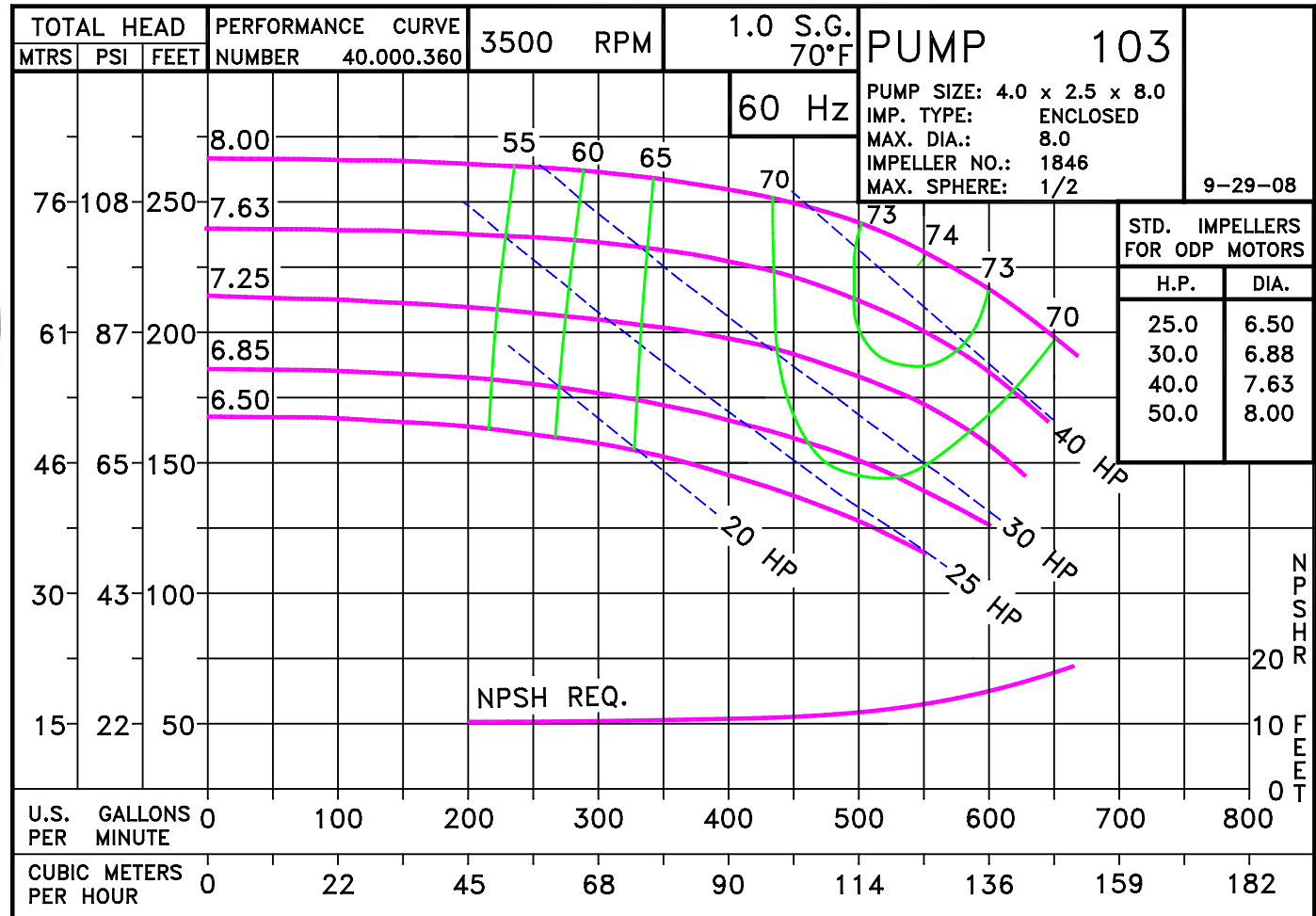

Pump 103 • Iron • JP Frame • 3500 RPM

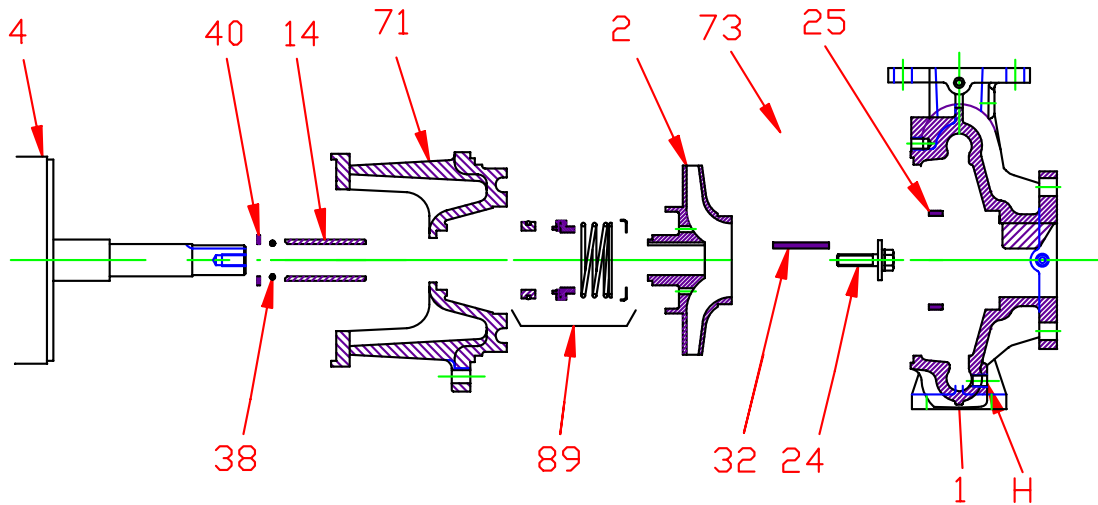

KEY NO.	PART NAME	PUMP NO. 103
1+	CASE, IRON, 4 x 2.5 FLG	130.000.309X
2	IMPELLER, 1¼" KEYED, ENCLOSED, SPECIFY DIAMETER: IRON	137.002.242
4	MOTOR, JP210/250 MOTOR, JP280/320	See Chart See Chart
14*	SHAFT SLEEVE, BRONZE SHAFT SLEEVE, STAINLESS	110.000.398 110.000.360
25	WEAR RING, BRONZE WEAR RING, STEEL	137.000.434 137.002.335
26*	IMPELLER RETAINER, STAINLESS	118.000.640
32*	KEY, STAINLESS	102.000.257
38*	O-RING, SHAFT, BUNA O-RING, SHAFT, VITON	116.000.218 116.000.218A
40*	FLINGER, STAINLESS	104.000.200
71	ADAPTER, IRON, JP210/250 ADAPTER, IRON, JP280/320	132.000.378X 132.000.387X
73*	GASKET, CASE, FIBER	116.000.276
89*	1¼" SEALS:	
	BN-CARB/CM	101.000.196
	VN-CARB/CM	101.000.216
	VN-CARB/SIL SEAL	101.000.221
	VN-SIL/SIL	101.000.231
	EPDM-CARB/SIL	101.000.196B
	EPDM-SIL/SIL	137.001.555
--	° REPAIR KITS:	
	BN-CARB/CM SEAL	118.000.410
	VN-CARB/CM SEAL (S)	118.000.410G
	VN-CARB/CM SEAL	118.000.410A
	VN-CARB/SIL SEAL	118.000.410B
	VN-SIL/SIL SEAL (S)	118.000.410H
	VN-SIL/SIL SEAL	118.000.410D
	EPDM-CARB/SIL SEAL	118.000.410C
EPDM-SIL/SIL SEAL	118.000.410E	

* DENOTES COMPONENTS INCLUDED IN REPAIR KIT.

+ INCLUDES BRONZE WEAR RING. FOR STEEL WEAR RING, REPLACE SUFFIX "X" WITH "X1"

° THE REPAIR KITS INCLUDE THE BRONZE SHAFT SLEEVE EXCEPT THE (S) INDICATED, WHICH IS STAINLESS

Pump 103 • Iron • JP Frame • 3500 RPM

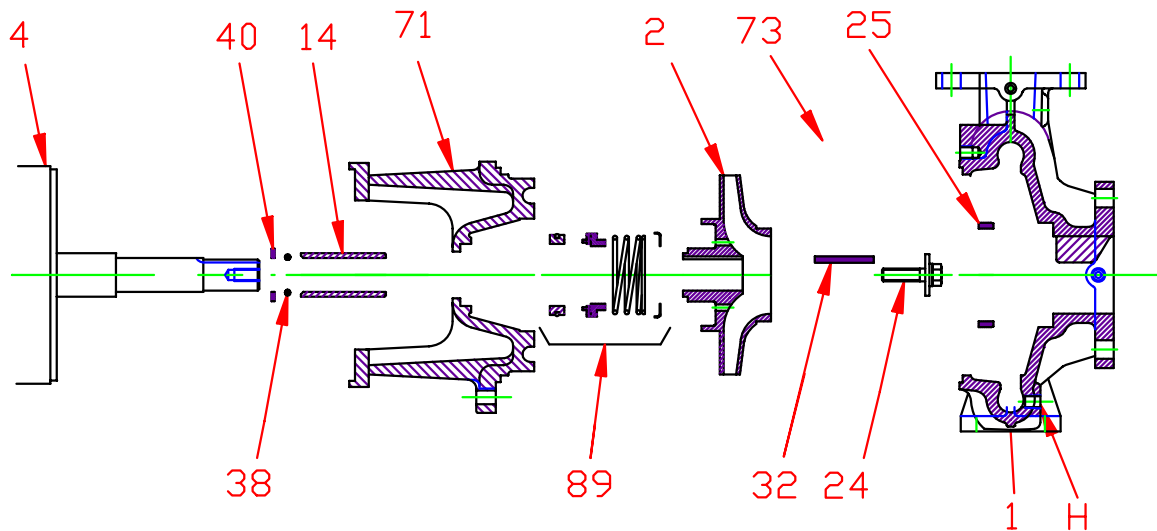

CONSTRUCTION OPTIONS

KEY	PART NAME	STANDARD FITTED	ALL IRON
1	Case	Iron	Iron
2	Impeller	Iron	Iron
14	Shaft Sleeve	Bronze	Stainless
25	Wear Ring, Case	Bronze	Steel
26	Impeller Retainer	Stainless	Stainless
32	Key	Stainless	Stainless
38	Shaft O-Ring	BUNA	BUNA
40	Flinger	Stainless	Stainless
71	Adapter	Iron	Iron
73	Gasket, Case	Fiber	Fiber
89	Mechanical Seal, Type 21 BN-CM	Standard	Standard
H	Plug, Drain	Brass	Plated Steel

E103JP

M14

C1033500JP