

MOTOR DIMENSIONS

NEMA JP FRAME 3 PHASE 1750 RPM

HP	Type	Frame	D	E	F	O	AB	BG	L	MH
3	ODP	JP182	4.50	3.75	2.25	7.81	5.61	5.75	6.25	.41
5	ODP	JP184	4.50	3.75	2.75	8.44	6.74	6.25	6.00	.41
7.5	ODP	JP213	5.25	4.25	2.75	10.03	7.97	7.22	5.31	.41
3	TEFC	JP182	4.50	3.75	2.25	8.85	7.57	5.01	7.14	.41
5	TEFC	JP184	4.50	3.75	2.75	8.85	7.57	5.51	7.64	.41
7.5	TEFC	JP213	5.25	4.25	2.75	10.41	8.67	6.00	8.41	.41

D103JP184

DRAWING DEPICTS 184JP 5HP ODP MOTOR

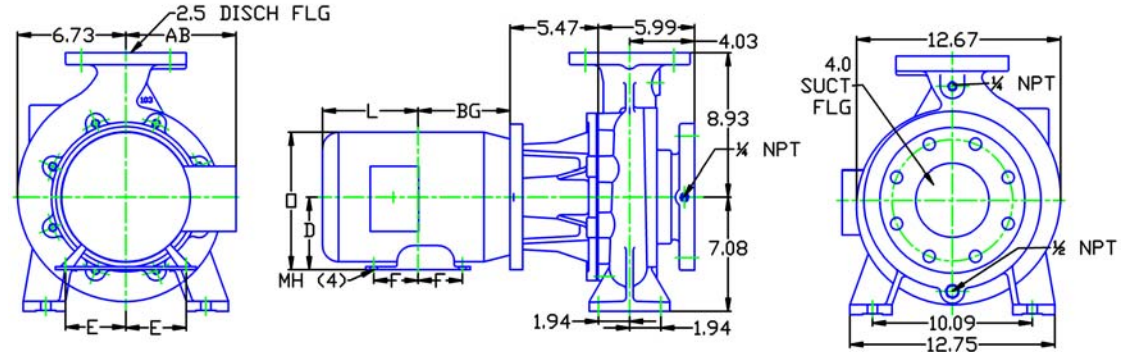

ALL DIMENSIONS IN INCHES.

DRAWING REPRESENTS APPROXIMATE PUMP DIMENSIONS. AUTOCAD DRAWING TO SCALE AVAILABLE FROM FACTORY.

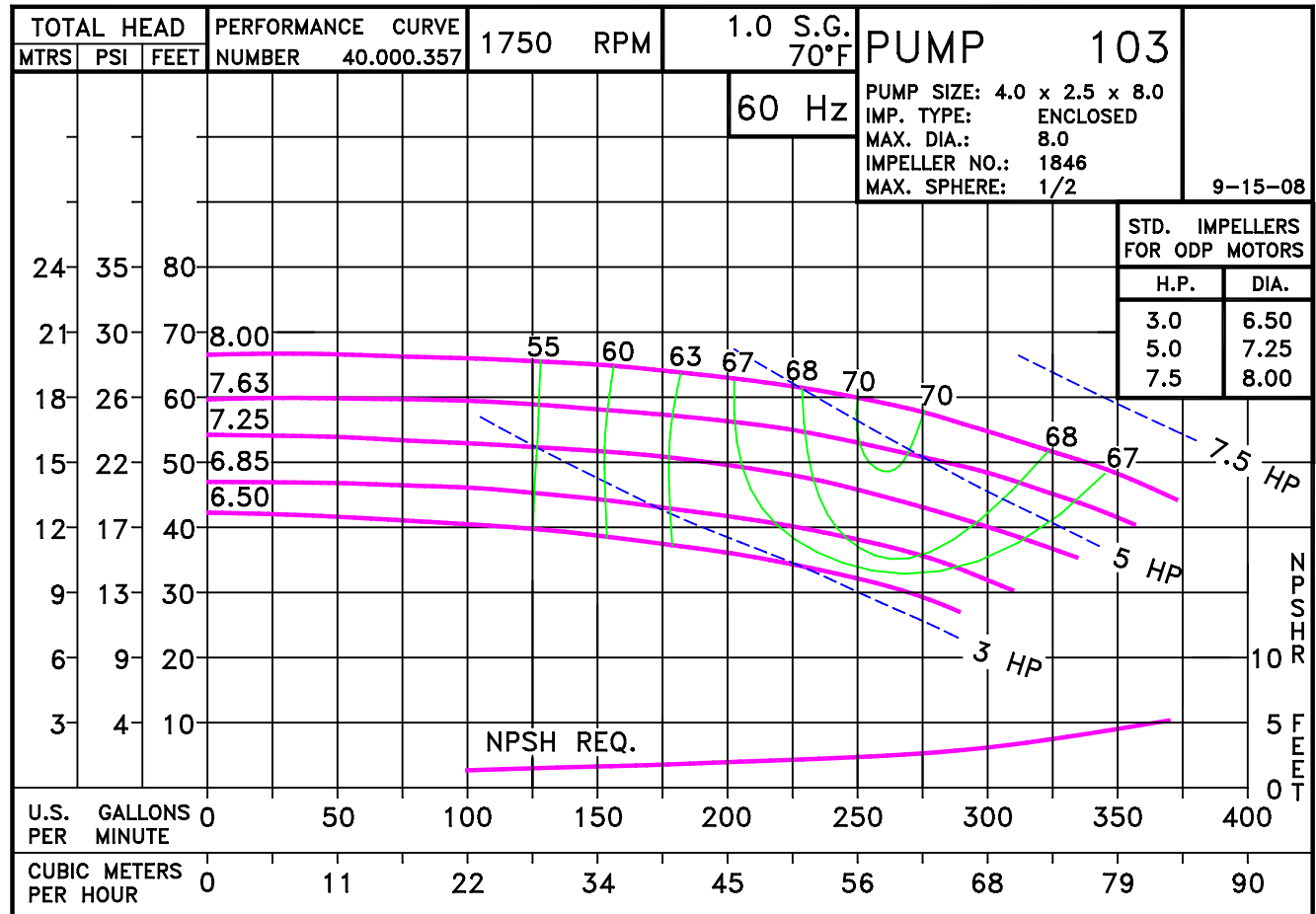

10205DP

D103JP184
1031750

103 JP

1031750JP
81.000.914 F14

Pump 103 • Iron • JP Frame • 1750 RPM

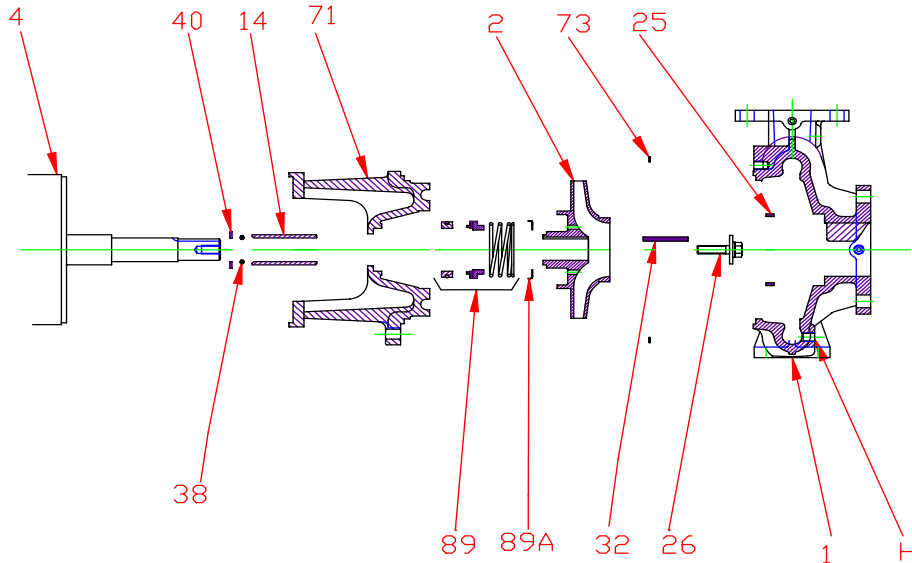

KEY NO.	PART NAME	PUMP NO. 103	
		3-5HP	7.5HP
1+	CASE, IRON, 4 x 2.5 FLG	130.000.309X	
2	IMPELLER, ENCLOSED, SPECIFY DIAMETER: IRON	7/8" KEYED 137.002.241	1 1/4" KEYED 137.002.242
4	MOTOR, JP140/180 MOTOR, JP210/250	See Chart --	-- See Chart
14*	SHAFT SLEEVE, BRONZE SHAFT SLEEVE, STAINLESS	110.000.399 110.000.361	110.000.398 110.000.360
25	WEAR RING, BRONZE WEAR RING, STEEL	137.000.434 137.002.335	
26*	IMPELLER RETAINER, STAINLESS	118.000.635	118.000.640
32*	KEY, STAINLESS	102.000.256	102.000.257
38*	O-RING, SHAFT, BUNA O-RING, SHAFT, VITON	116.000.117 116.000.105	116.000.218 116.000.218A
40*	FLINGER, STAINLESS	104.000.256	104.000.200
71	ADAPTER, IRON, JP140/180 ADAPTER, IRON, JP210/250	132.000.391 --	-- 132.000.378X
73*	GASKET, CASE, FIBER	116.000.276	
89*	SEALS:	1 1/2"	1 3/4"
	BN-CARB/CM	101.000.168	101.000.196
	VN-CARB/CM	101.000.191	101.000.216
	VN-CARB/SIL	101.000.175	101.000.221
	VN-SIL/SIL	101.000.204	101.000.231
	EPDM-CARB/SIL EPDM-SIL/SIL	101.000.175B 101.000.204A	101.000.196B 137.001.555
89A*	SEAL SPRING RETAINER	104.000.174	<i>Included w/Seal</i>
--	° REPAIR KITS:		
	BN-CARB/CM SEAL	118.000.413	118.000.410
	VN-CARB/CM SEAL (S)	118.000.413F	118.000.410G
	VN-CARB/CM SEAL	118.000.413A	118.000.410A
	VN-CARB/SIL SEAL	118.000.413B	118.000.410B
	VN-SIL/SIL SEAL (S)	118.000.413G	118.000.410H
	VN-SIL/SIL SEAL	118.000.413C	118.000.410D
	EPDM-CARB/SIL SEAL EPDM-SIL/SIL SEAL	118.000.413D 118.000.413E	118.000.410C 118.000.410E

* DENOTES COMPONENTS INCLUDED IN REPAIR KIT.
 + INCLUDES BRONZE WEAR RING. FOR STEEL WEAR RING, REPLACE SUFFIX "X" WITH "X1"
 ° THE REPAIR KITS INCLUDE THE BRONZE SHAFT SLEEVE EXCEPT THE (S) INDICATED, WHICH IS STAINLESS

Pump 103 • Iron • JP Frame • 1750 RPM

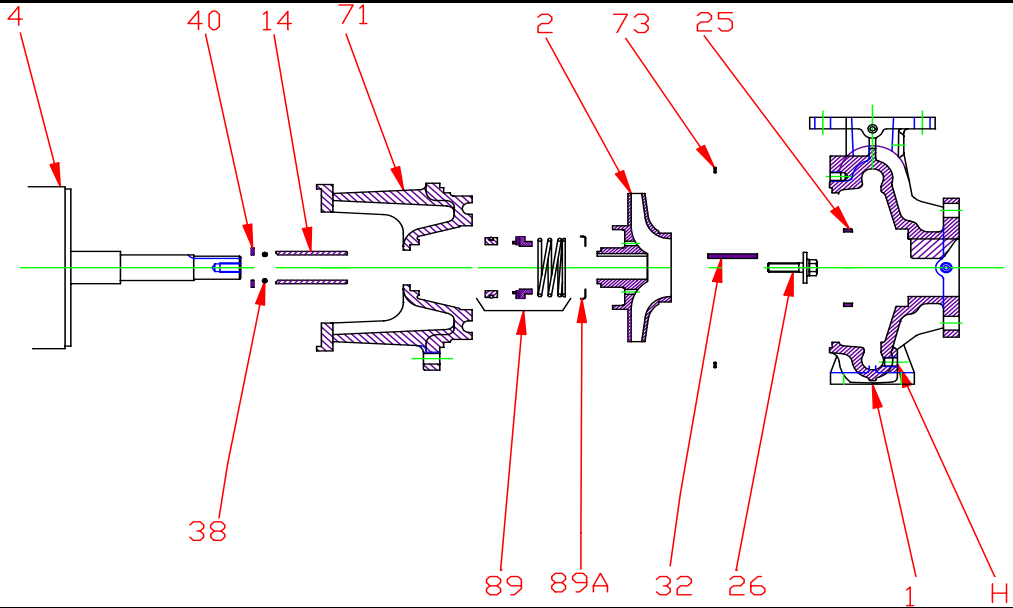

CONSTRUCTION OPTIONS

KEY	PART NAME	STANDARD FITTED	ALL IRON
1	Case	Iron	Iron
2	Impeller	Iron	Iron
14	Shaft Sleeve	Bronze	Stainless
25	Wear Ring, Case	Bronze	Steel
26	Impeller Retainer	Stainless	Stainless
32	Key	Stainless	Stainless
38	Shaft O-Ring	BUNA	BUNA
40	Flinger	Stainless	Stainless
71	Adapter	Iron	Iron
73	Gasket, Case	Fiber	Fiber
89	Mechanical Seal, Type 21 BN-CM	Standard	Standard
89A*	Seal Spring Retainer	Stainless	Stainless
H	Plug, Drain	Brass	Plated Steel

* Included with seal on 7.5HP

E103JP180

H15

C1031750JP