

MOTOR DIMENSIONS

D102JP182

DRAWING DEPICTS 182JP 3HP ODP MOTOR

NEMA PREMIUM EFFICIENT JP FRAME 3 PHASE 1750 RPM

HP	Type	Frame	D	E	F	O	AB	BG	L	MH
2	ODP	JP145	3.50	2.75	2.50	6.75	5.42	4.75	5.07	0.34
3	ODP	JP182	4.50	3.75	2.25	8.31	6.12	5.00	5.73	0.41
5	ODP	JP184	4.50	3.75	2.25	8.31	6.12	5.00	6.52	0.41
1.5	TEFC	JP145	3.50	2.75	2.50	7.00	6.25	5.06	6.34	.34
2	TEFC	JP145	3.50	2.75	2.50	7.00	6.25	5.06	6.34	.34
3	TEFC	JP182	4.50	3.75	2.25	8.85	7.57	5.01	7.14	.41
5	TEFC	JP184	4.50	3.75	2.75	8.85	7.57	5.51	7.64	.41

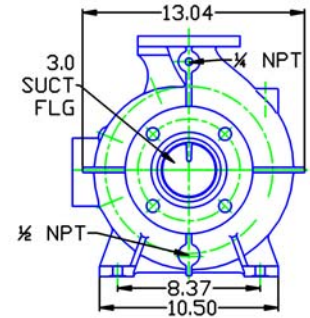
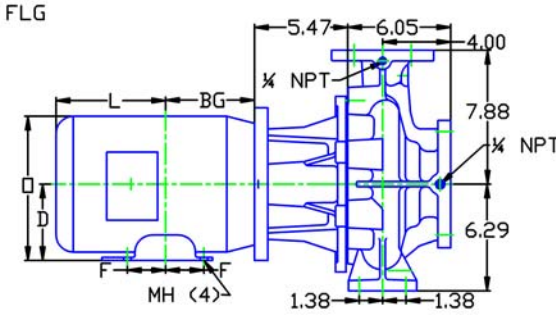
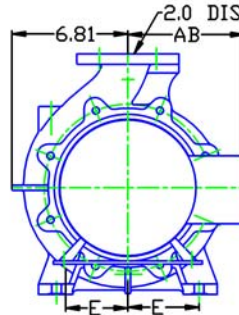

ALL DIMENSIONS IN INCHES.

DRAWING REPRESENTS APPROXIMATE PUMP DIMENSIONS. AUTOCAD DRAWING TO SCALE AVAILABLE FROM FACTORY.

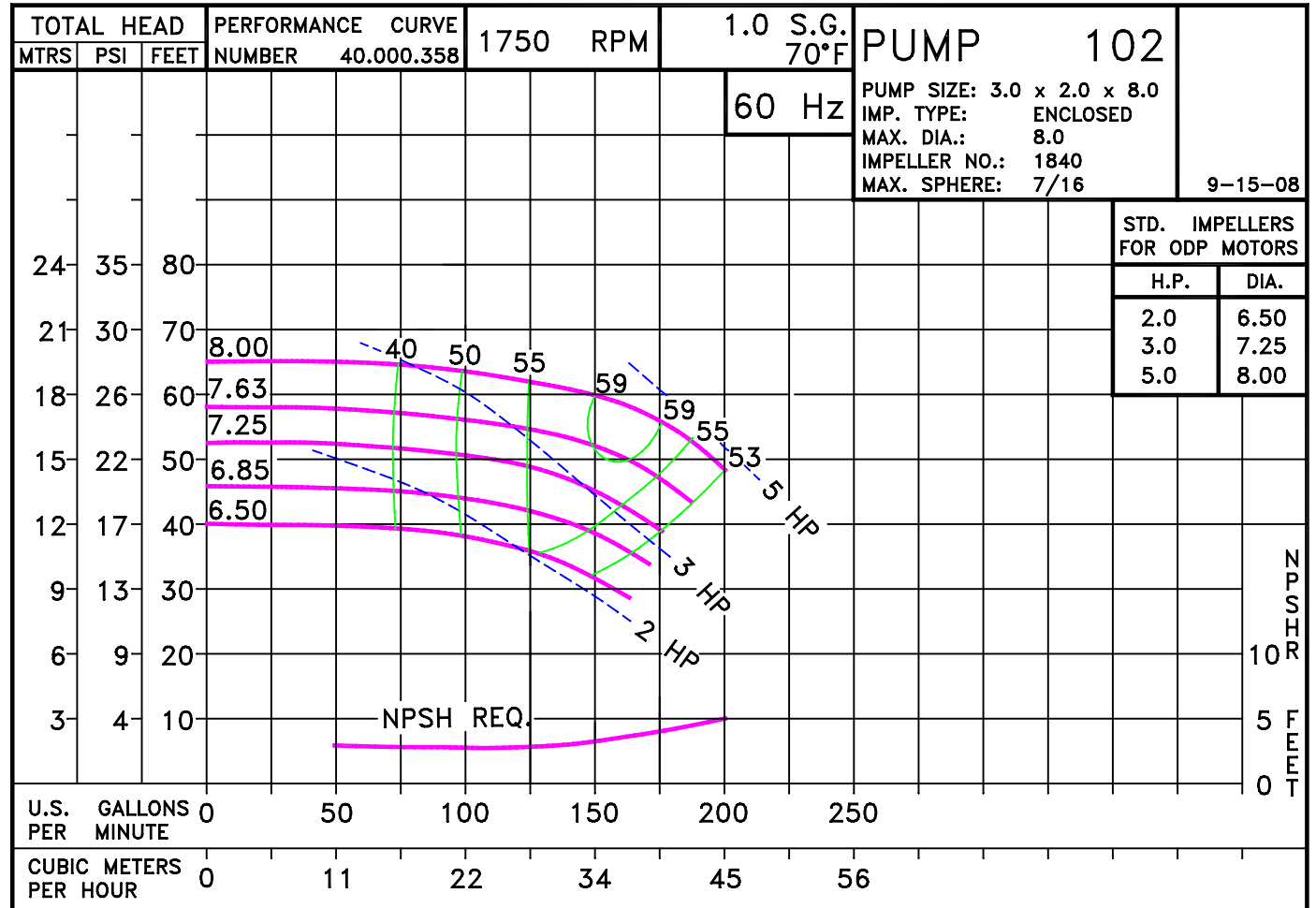

10205DP

D102JP182
1021750

102 JP

1021750JP
81.000.927 J16

Pump 102 • Iron • JP Frame • 1750 RPM

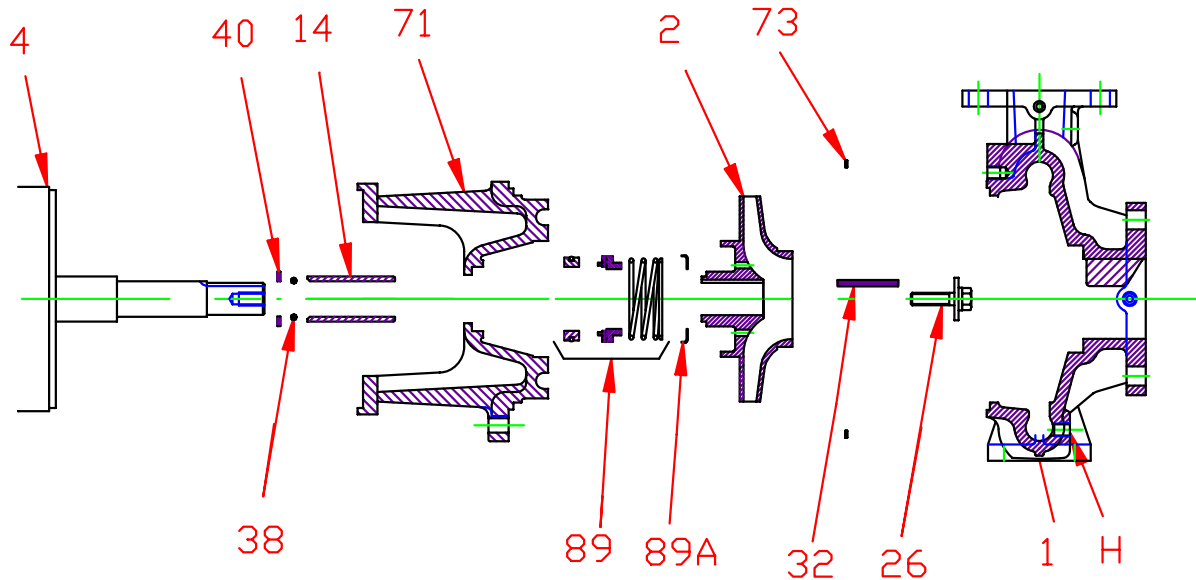

KEY NO.	PART NAME	PUMP NO. 102
1	CASE, IRON, 3 x 2 FLG	130.000.308X
2	IMPELLER, 7/8" KEYED, ENCLOSED, SPECIFY DIAMETER: IRON	137.000.174
4	MOTOR, JP140/180	See Chart
14*	SHAFT SLEEVE, BRONZE	110.000.399
	SHAFT SLEEVE, STAINLESS	110.000.361
26*	IMPELLER RETAINER, STAINLESS	118.000.635
32*	KEY, STAINLESS	102.000.256
38*	O-RING, SHAFT, BUNA	116.000.117
	O-RING, SHAFT, VITON	116.000.105
40*	FLINGER, STAINLESS	104.000.256
71	ADAPTER, IRON, JP140/180	132.000.391
73*	GASKET, CASE, FIBER	116.000.276
	1½" SEALS:	
89*	BN-CARB/CM	101.000.168
	VN-CARB/CM	101.000.191
	VN-CARB/SIL	101.000.175
	VN-SIL/SIL	101.000.204
	EPDM-CARB/SIL	101.000.175B
	EPDM-SIL/SIL	101.000.204A
89A*	SEAL RETAINER, STAINLESS	104.000.174
	° REPAIR KITS:	
--	BN-CARB/CM SEAL	118.000.413
	VN-CARB/CM SEAL (S)	118.000.413F
	VN-CARB/CM SEAL	118.000.413A
	VN-CARB/SIL SEAL	118.000.413B
	VN-SIL/SIL SEAL (S)	118.000.413G
	VN-SIL/SIL SEAL	118.000.413C
	EPDM-CARB/SIL SEAL	118.000.413D
	EPDM-SIL/SIL SEAL	118.000.413E

* DENOTES COMPONENTS INCLUDED IN REPAIR KIT.

° THE REPAIR KITS INCLUDE THE BRONZE SHAFT SLEEVE EXCEPT THE (S) INDICATED, WHICH IS STAINLESS

Pump 102 • Iron • JP Frame • 1750 RPM

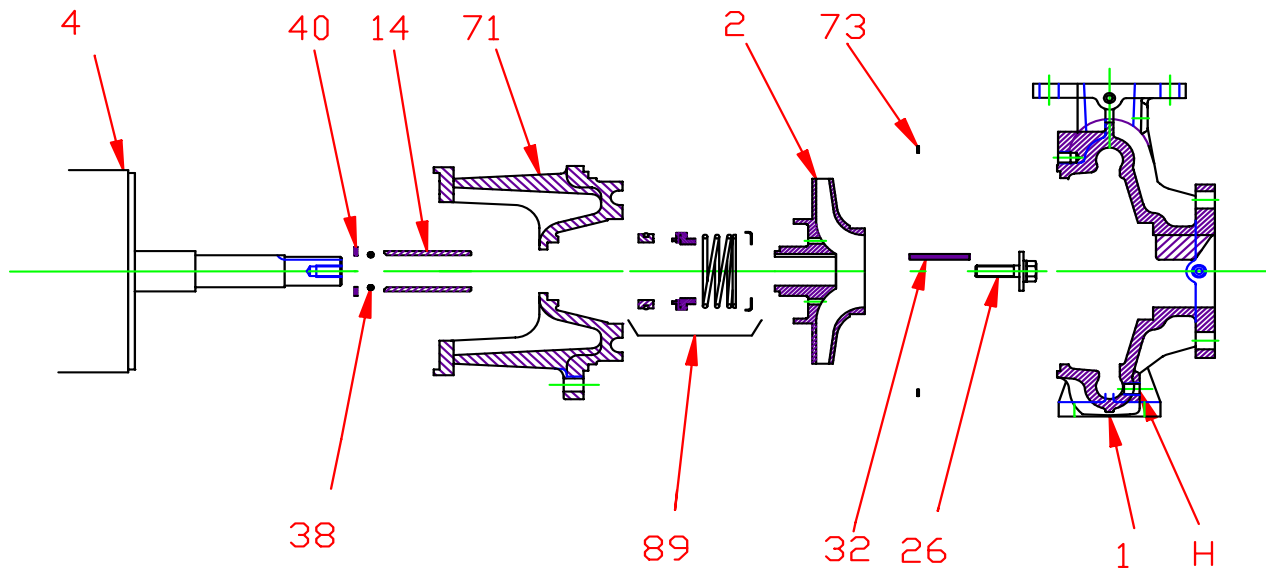

CONSTRUCTION OPTIONS

KEY	PART NAME	STANDARD FITTED	ALL IRON
1	Case	Iron	Iron
2	Impeller	Iron	Iron
14	Shaft Sleeve	Bronze	Stainless
26	Impeller Retaining Assy	Stainless	Stainless
32	Key	Stainless	Stainless
38	Shaft O-Ring	BUNA	BUNA
40	Flinger	Stainless	Stainless
71	Adapter	Iron	Iron
73	Gasket, Case	Fiber	Fiber
89	Mechanical Seal, Type 21 BN-CM	Standard	Standard
89A	Seal Spring Retainer	Stainless	Stainless
H	Plug, Drain	Brass	Plated Steel