

SSBH SERIES

STAINLESS STEEL BAG HOUSING

DESCRIPTION

SSBH Series Stainless Steel Filter Bag Housing is a classic high-efficiency filtration system, which is made of 304 or 316L stainless steel (SS). The SS filter bag housing supports the SS mesh basket inside the bag housing. The liquid flows in from the side inlet and flows out from the side or bottom outlet after being filtered by the filter bag, where the debris is intercepted in the filter bag.

The Stainless steel filter bag housing is suitable for installing filter bags of various sizes and materials. SS filter bag housing forms a good seal to eliminate prefiltered water from bypassing the bag which boasts a higher filter efficiency. The system has a wide range of chemical compatibility and is suitable for a wide range of industrial and commercial fluid filtration applications.

FEATURES

- Better Sealing Effect for Preventing Side Leakage
- Large Effective Filtration Area
- Higher Filtration Efficiency
- Wide Range of Applications
- Long Service Life



SPECIFICATION

Material	SS304, SS316L
Top Style	Side Entering Type
Surface Treatment	Polished, Sandblast
Bag Size	Size 2: 7"x 32"
No. of Bag	1pc
Connection	2" Flanged
Inlet/Outlet	Side In and Bottom Out, Side In and Side Out
Sealing Type	Swing bolt hinged with Viton O-Ring

OPERATION DATA

Max. Temperature	257F
Max. Pressure	150 PSI
Max. Flow Rate	176 gpm

FLOW RATE

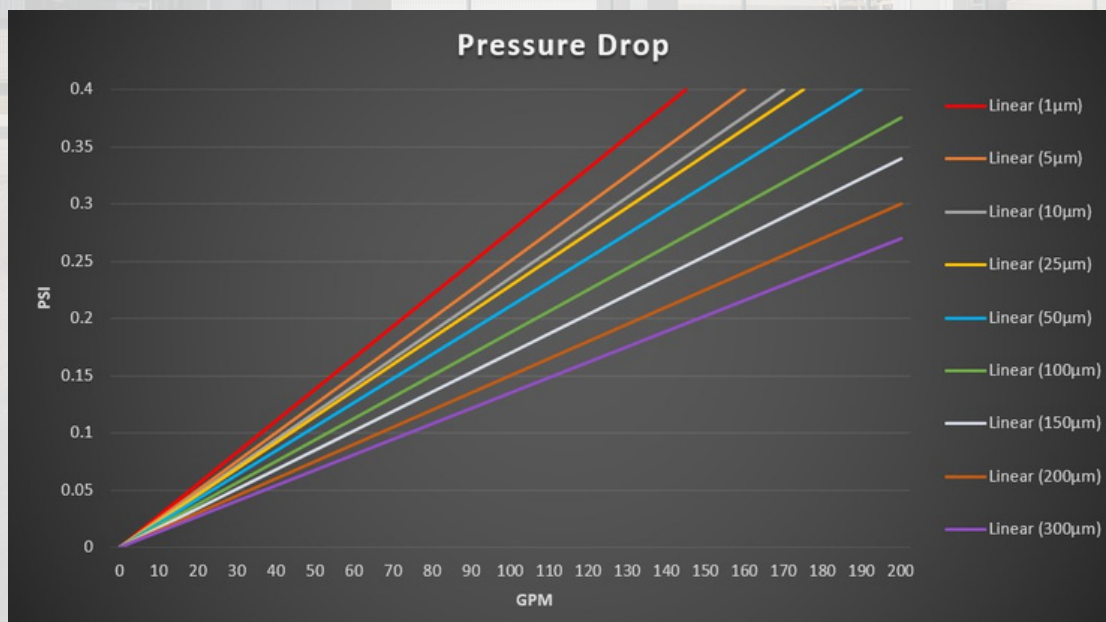

TECH SUPPORT

Detail of Stainless Steel Filter Bag Housing

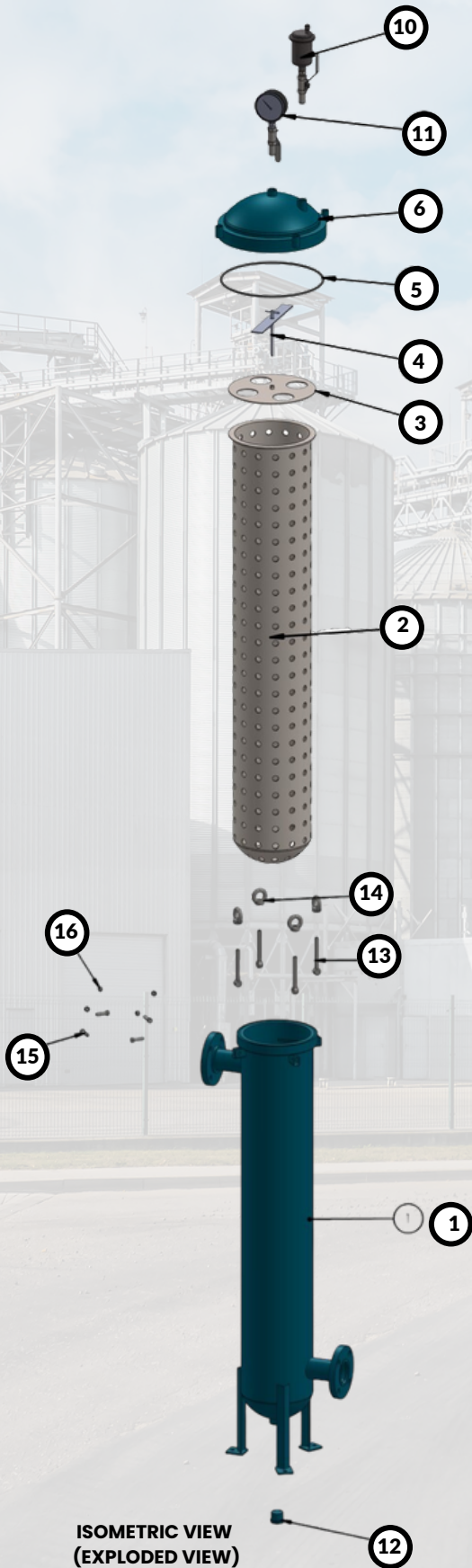

APPLICATIONS

- Pre RO
- Chemicals
- Electronics
- Automobiles
- Textile Industry
- Water Treatment
- Food & Beverage
- Paints & Coatings
- Cooling Tower Systems
- Chilled water Systems

ITEM NO.	DESCRIPTION	MATERIAL	QTY.
1	FILTER HOUSING	STAINLESS STEEL	1
2	BASKET STRAINER WITH BAG	STAINLESS STEEL + CLOTH	1
3	BASKET STRAINER COVER	STAINLESS STEEL	1
4	COVER HANDLE	STAINLESS STEEL	1
5	O-RING	FKM	1
6	UPPER COVER	STAINLESS STEEL	1
10	1/8" FNPT, AUTOMATIC AIR VENT (B&G) WITH NIPPLE VALVE	CAST IRON	1
11	PRESSURE GAUGE, WITH NIPPLE VALVE, 1/4" CONN	STAINLESS STEEL	1
12	1" HEX HEAD PLUG, 150# NPT	STAINLESS STEEL	1
13	EYE END BOLT	STAINLESS STEEL	4
14	EYE NUT	STAINLESS STEEL	4
15	HEX BOLT	STAINLESS STEEL	4
16	HEX NUT	STAINLESS STEEL	4

ISOMETRIC VIEW
(EXPLODED VIEW)

STAINLESS STEEL - BAG FILTER LAYOUT

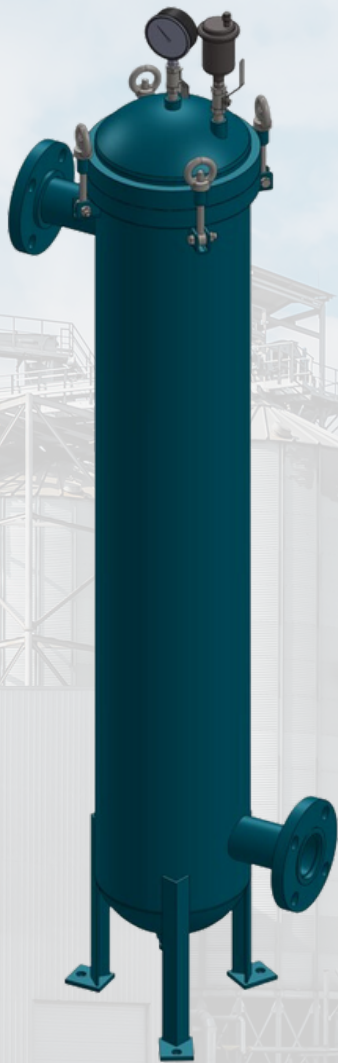

ISOMETRIC VIEW

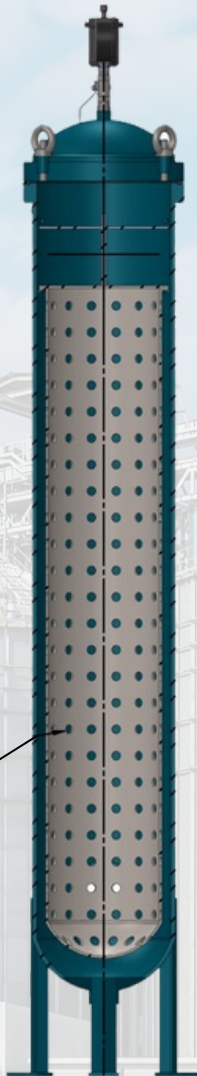

LEFT SIDE VIEW

BASKET STRAINER AND BAG (INSIDE)

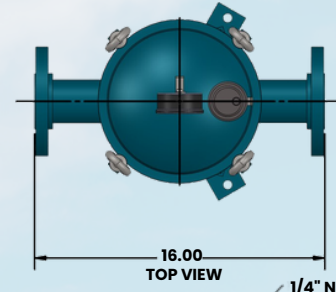

16.00
TOP VIEW

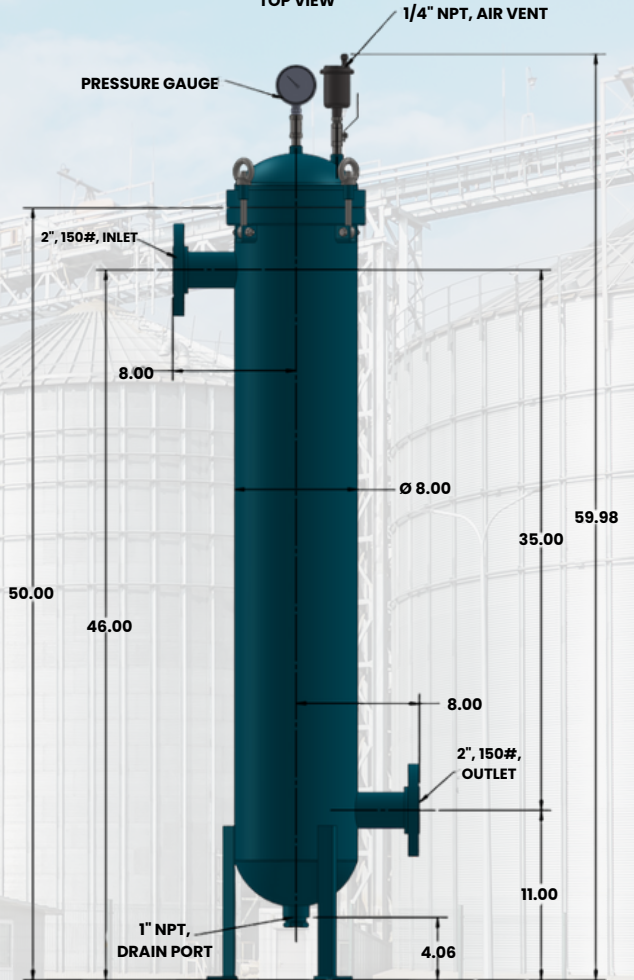

PRESSURE GAUGE

1/4" NPT, AIR VENT

2", 150#, INLET

8.00

Ø 8.00

35.00

59.98

50.00

46.00

8.00

2", 150#,
OUTLET

11.00

1" NPT,
DRAIN PORT

4.06

FRONT VIEW

ORDER INFORMATION

SSBH	Filter Bag Size	No. of Bag	Material	Inlet/Outle	Seal Material
SSBH Series SS Filter Bag Housing -Side Entering Type	02 =Size 2: 07"x 32"	1=1pc	S4 = SS304	2 inch	E = EPDM
			S6 = SS316L		S = Silicon
					B = Buna N
					V = Viton

For Example:

SSBF-02-1-S6-50-S

SSBH Series Stainless Steel Bag housing

- Size 2: 07">> 32" - 1pc - SS316L - 2" Flanged - Silicon