

60 HERTZ, 2 X 2 X 4.38 NPT

D074J56

DRAWING DEPICTS S6J 1PHASE TEFC MOTOR

MOTOR DIMENSIONS

NEMA J56 FRAME 3500 RPM

HP	TYPE	3 PHASE				1 PHASE			
		L	O	AB	C	L	O	AB	C
2.0	ODP	8.87	6.50	3.25	18.71	10.31	8.37	3.25	20.15
3.0	ODP	9.37	6.50	3.25	19.21	10.81	8.37	3.25	20.65
3.0	TEFC	11.30	7.33	5.88	22.87	12.16	8.10	5.31	22.00

Use 3 HP for TEFC motor.

Motors are Standard Efficient with the exception of the 3HP 3phase TEFC that is Premium Efficient.

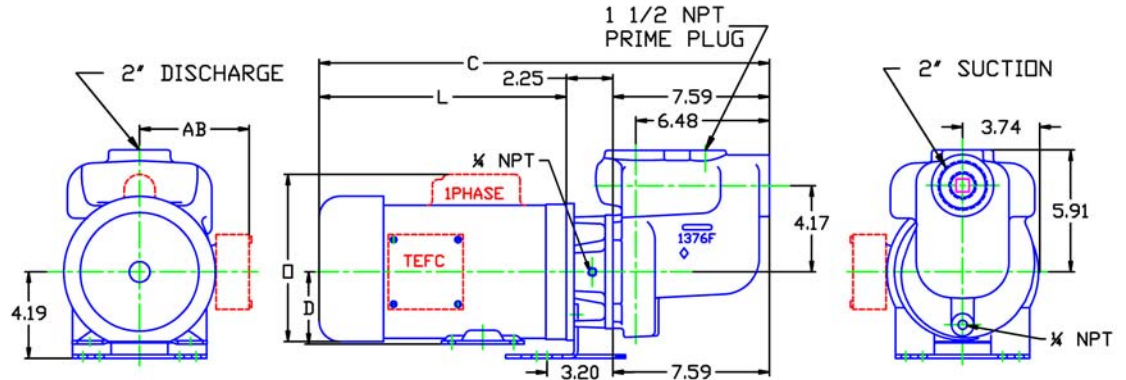

ALL DIMENSIONS IN INCHES

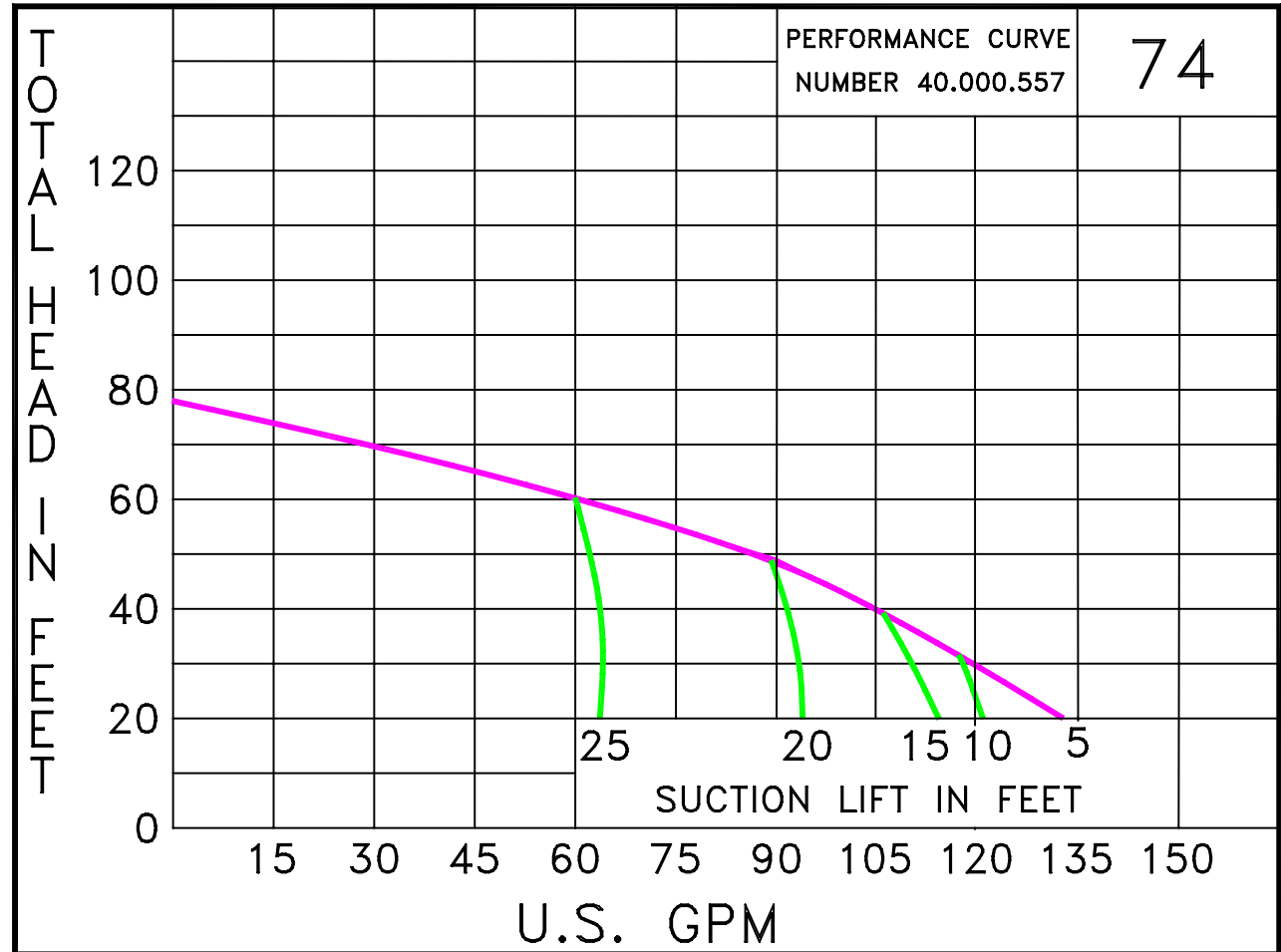
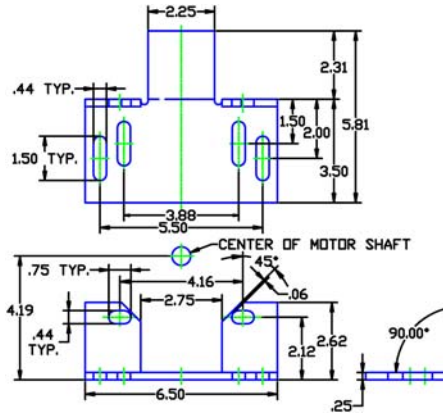

D1482 0742TE D074j56 0743500

74
J56

0743500J56
81.001.317 L16

Pump 74 • Iron • J56 Frame • 3500 RPM

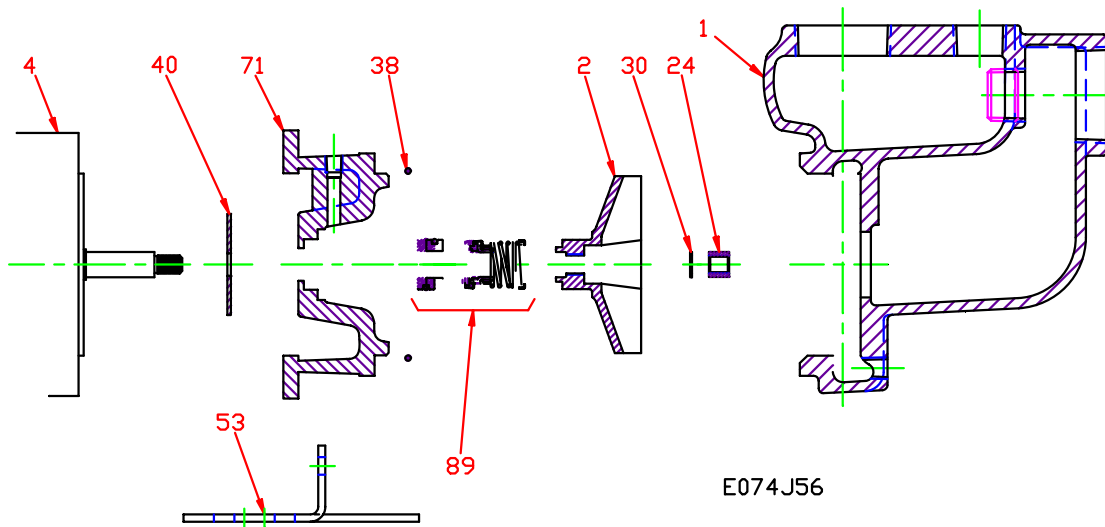

E074J56

KEY NO.	PART NAME	Pump 74	
1	CASE, IRON, 2 x 2 NPT	130.000.239X	
2	IMPELLER, 7/16" THREADED, SEMI-OPEN, SPECIFY DIAMETER:		
	IRON	131.000.315	
	BRONZE	131.000.316	
4	MOTOR:		
	J56, ROUND BODY J56, 3.5" RIGID BASE	See Chart See Chart	
24*+	NUT, STAINLESS	105.000.465	
30*+	D WASHER, STAINLESS	104.000.168	
40*	FLINGER, NEOPRENE	104.000.171	
53	BASE, STEEL	137.000.652	
71	ADAPTER, IRON	132.000.207X	
73*	GASKET, CASE, BUNA	116.000.141	
89*	5/8" SEALS:		
	NO RETAINER:		
	TYPE 6, BN-CARB/CM	101.000.110	
	WITH RETAINER:		
	TYPE 21, VN-CARB/CM	101.000.103	
	TYPE 21, VN-CARB/SIL	101.000.120	
	TYPE 21, VN-SIL/SIL	101.000.239	
	TYPE 21, EPDM-CARB/SIL	101.000.173	
	TYPE 21, EPDM-SIL/SIL	101.000.236	
--	REPAIR KITS:	† 1 PHASE:	3 PHASE:
	BN-CARB/CM SEAL	118.000.341.1	118.000.341
	VN-CARB/CM SEAL	118.000.341A.1	118.000.341A
	VN-CARB/SIL SEAL	118.000.341B.1	118.000.341B
	VN-SIL/SIL SEAL	118.000.341F.1	118.000.341F
	EPDM-CARB/SIL SEAL	118.000.341C.1	118.000.341C
	EPDM-SIL/SIL SEAL	118.000.341D.1	118.000.341D
* DENOTES COMPONENTS INCLUDED IN REPAIR KIT.			
† USE 3 PHASE KIT ON 2-3 HP 1 PHASE MOTORS.			