

Pump 17S • 316SS • TC Frame • 3500 RPM

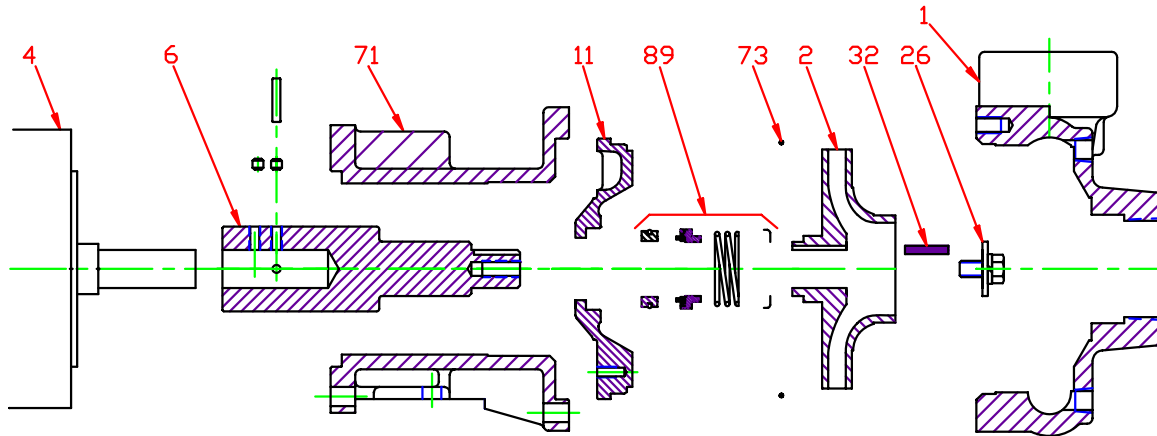

KEY NO.	PART NAME	TC140	TC180
1	CASE, 316SS, 2 x 2 NPT	130.000.265X	
2	IMPELLER, 7/8" KEYED, ENCLOSED, SPECIFY DIAMETER: 316 STAINLESS STEEL	137.000.242	
4	MOTOR, TC	See Chart	See Chart
6*+	STUB SHAFT ASS'Y, 316SS	135.000.221X	135.000.221AX
11	BACKPLATE, 316SS	132.000.224	
26*	IMPELLER RETAINER, 316SS	118.000.111C	
32*	KEY, 316SS	102.000.218	
71	ADAPTER, IRON	132.000.120	132.000.122
73*	GASKET, CASE, VITON	116.000.150	
89*	SEAL, 1¼", VN-SIL/SIL	101.000.203A	
--	REPAIR KIT, VN-SIL/SIL	118.000.539A	118.000.540A
* DENOTES COMPONENTS INCLUDED IN REPAIR KIT.			
+ ASS'Y INCLUDES STUB SHAFT, PIN, SET SCREWS AND KEY.			

E017STC

H12

P017S3500TC

Pump 17S • 316SS • TC Frame • 3500 RPM

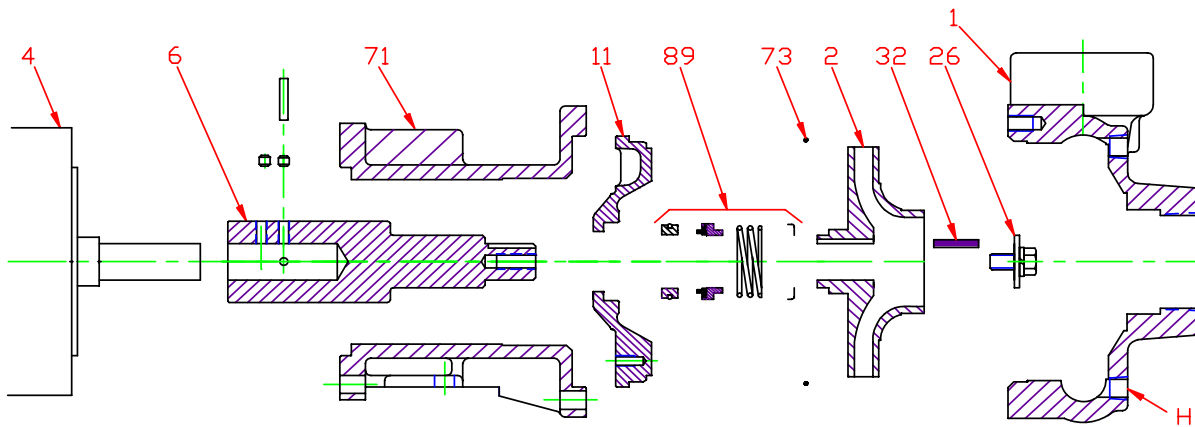

CONSTRUCTION OPTIONS		
KEY NO.	PART NAME	STANDARD FITTED
1	CASE	316SS
2	IMPELLER	316SS
6	STUB SHAFT ASS'Y	316SS
11	BACKPLATE	316SS
26	IMPELLER RETAINER	316SS
32	KEY	316SS
71	ADAPTER	IRON
73	GASKET, CASE	VITON
89	SEAL ASSEMBLY	VN-SIL/SIL
H	PLUG, DRAIN	316SS

E017STC

C15

C017S3500TC