

MOTOR DIMENSIONS

NEMA TC FRAME 3 PHASE 3500 RPM

HP	TYPE	Frame	D	E	F	O	AB	BG	L	MH
1.5	TEFC	TC143	3.50	2.75	2.00	7.12	6.18	4.25	6.31	.34
2	TEFC	TC145	3.50	2.75	2.50	7.12	6.18	4.75	6.31	.34
3	TEFC	TC182	4.50	3.75	2.25	9.34	7.56	5.00	6.99	.41
5	TEFC	TC184	4.50	3.75	2.75	9.34	7.56	5.50	7.49	.41
7.5	TEFC	TC213	5.25	4.25	2.75	10.84	8.58	6.25	8.40	.41

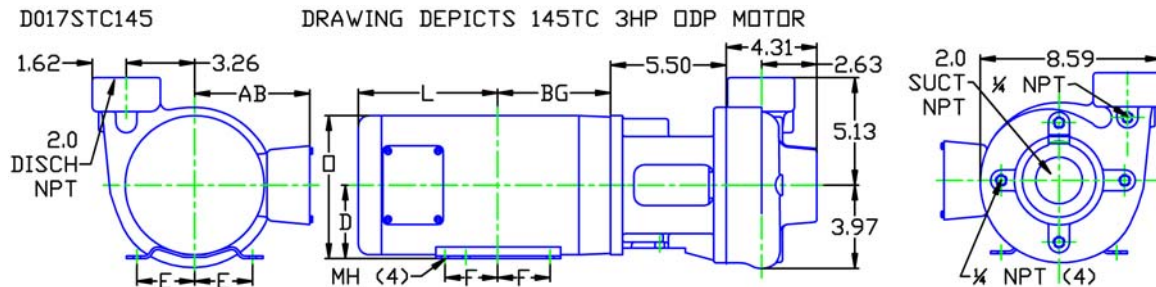

ALL DIMENSIONS IN INCHES.

DRAWING REPRESENTS APPROXIMATE PUMP DIMENSIONS. AUTOCAD DRAWING TO SCALE AVAILABLE FROM FACTORY.

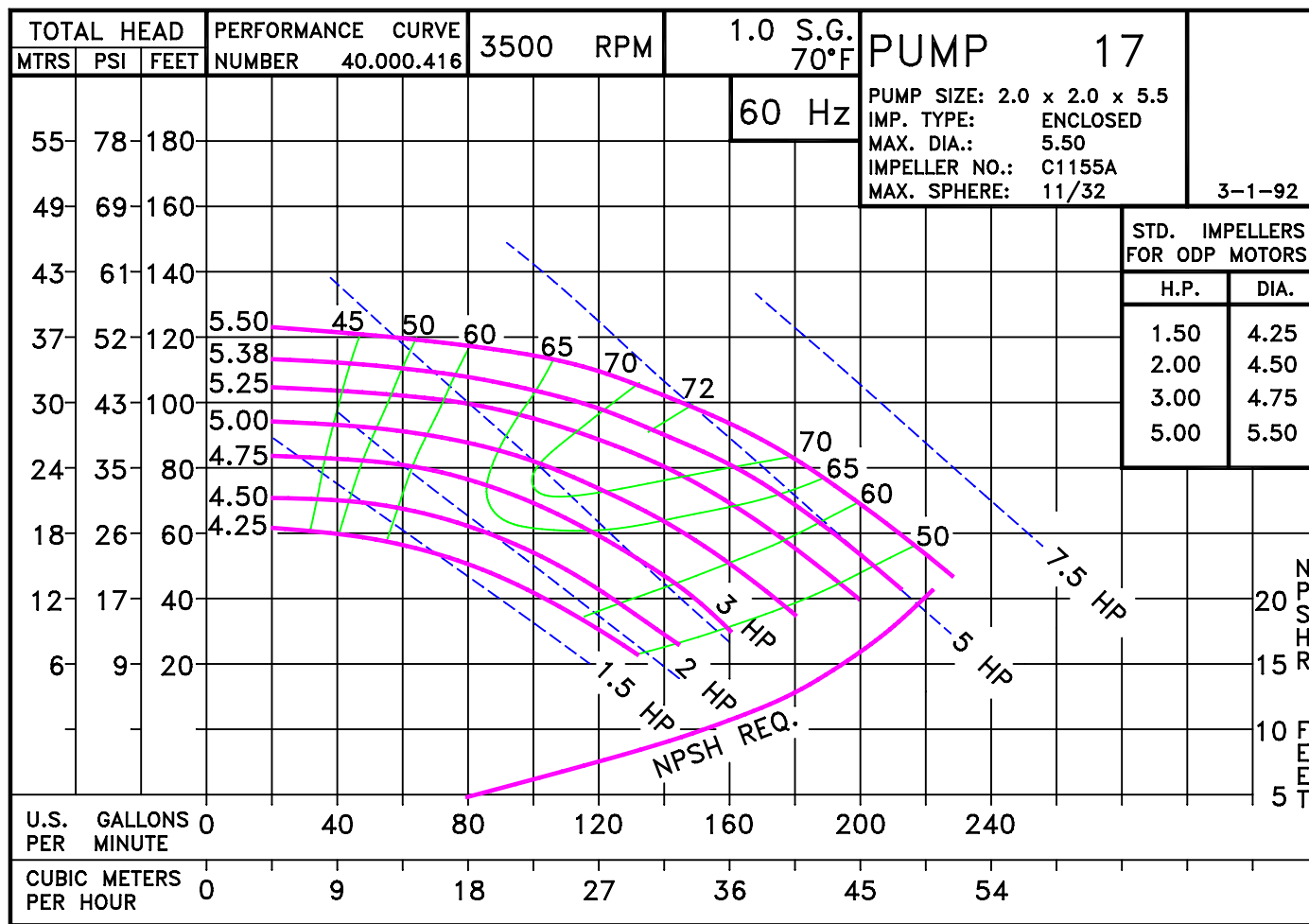

0173DP

D017STC145
0173500

17S TC

017S3500TC
81.001.321 J12

Pump 17S • 316SS • TC Frame • 3500 RPM

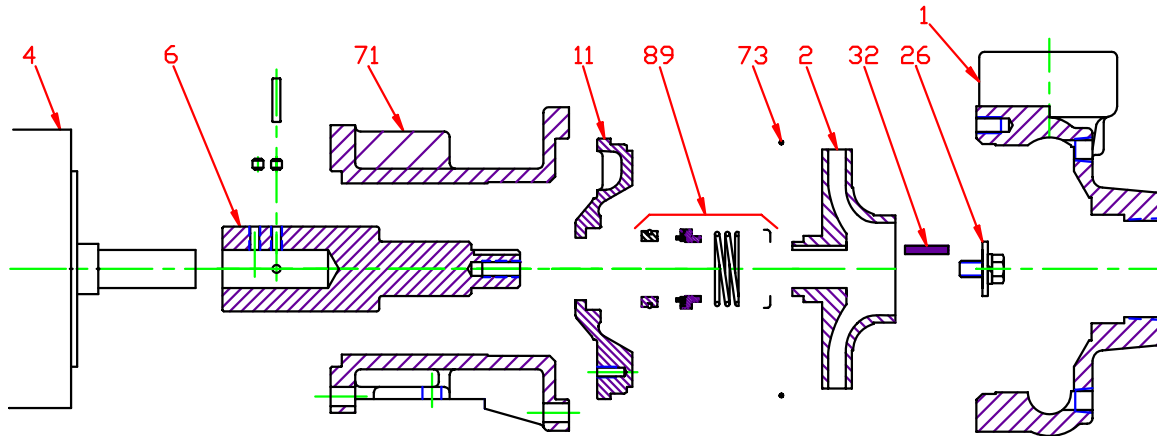

KEY NO.	PART NAME	TC140	TC180
1	CASE, 316SS, 2 x 2 NPT	130.000.265X	
2	IMPELLER, 7/8" KEYED, ENCLOSED, SPECIFY DIAMETER:		
	316 STAINLESS STEEL	137.000.242	
4	MOTOR, TC	See Chart	See Chart
6*	STUB SHAFT ASS'Y, 316SS	135.000.221X	135.000.221AX
11	BACKPLATE, 316SS	132.000.224	
26*	IMPELLER RETAINER, 316SS	118.000.111C	
32*	KEY, 316SS	102.000.218	
71	ADAPTER, IRON	132.000.120	132.000.122
73*	GASKET, CASE, VITON	116.000.150	
89*	SEAL, 1¼", VN-SIL/SIL	101.000.203A	
--	REPAIR KIT, VN-SIL/SIL	118.000.539A	118.000.540A
* DENOTES COMPONENTS INCLUDED IN REPAIR KIT.			
+ ASS'Y INCLUDES STUB SHAFT, PIN, SET SCREWS AND KEY.			

E017STC

H12

P017S3500TC

Pump 17S • 316SS • TC Frame • 3500 RPM

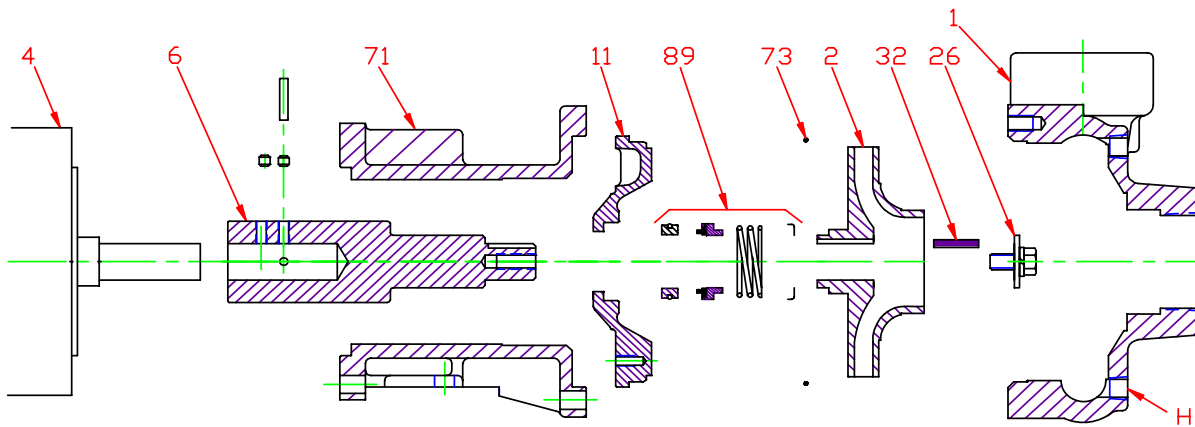

CONSTRUCTION OPTIONS		
KEY NO.	PART NAME	STANDARD FITTED
1	CASE	316SS
2	IMPELLER	316SS
6	STUB SHAFT ASS'Y	316SS
11	BACKPLATE	316SS
26	IMPELLER RETAINER	316SS
32	KEY	316SS
71	ADAPTER	IRON
73	GASKET, CASE	VITON
89	SEAL ASSEMBLY	VN-SIL/SIL
H	PLUG, DRAIN	316SS

E017STC

C15

C017S3500TC