

MOTOR DIMENSIONS

NEMA C56 FRAME 1750 RPM

HP	FRAME	ODP			TEFC		
		L	O	AB	L	O	AB
.75	C56	9.78	6.19	5.06	9.87	7.25	5.88

See JM frame for 1 – 1.5 HP

D015C56

DRAWING DEPICTS 56C ODP MOTOR

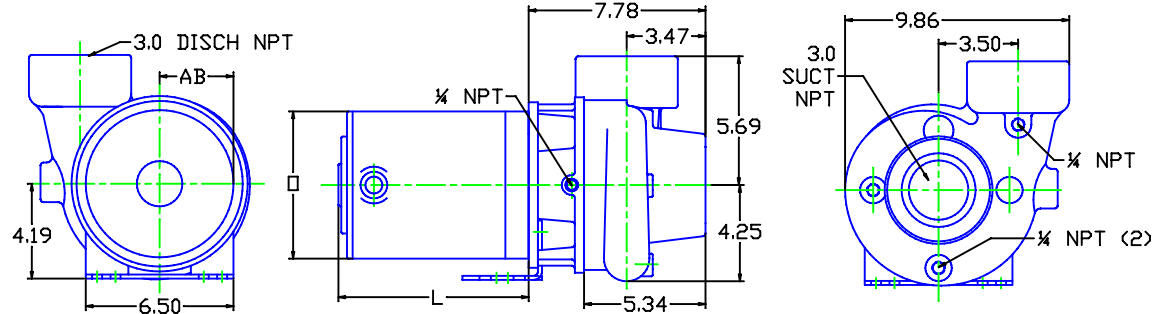

ALL DIMENSIONS IN INCHES.

DRAWING REPRESENTS APPROXIMATE PUMP DIMENSIONS. AUTOCAD DRAWING TO SCALE AVAILABLE FROM FACTORY.

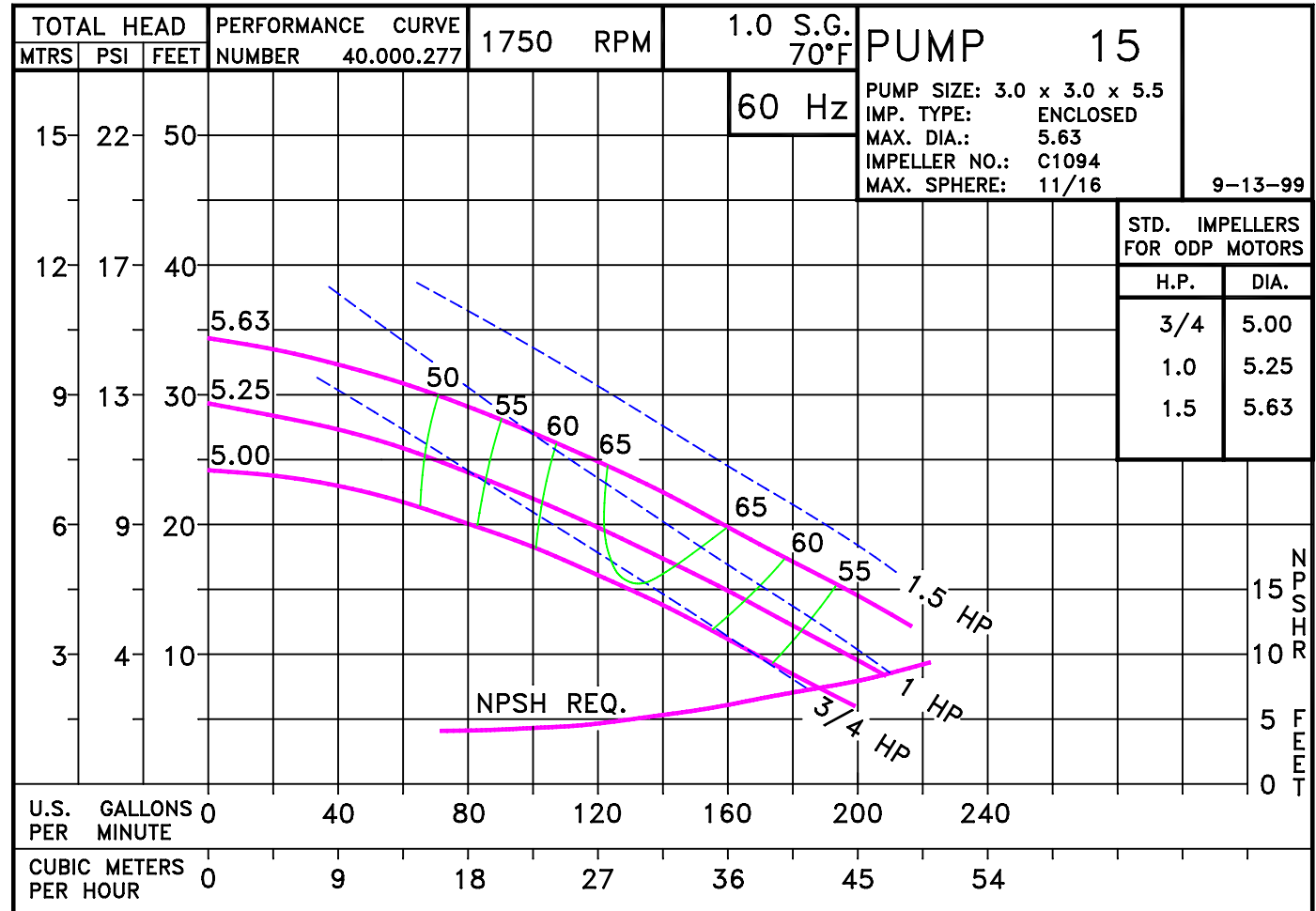
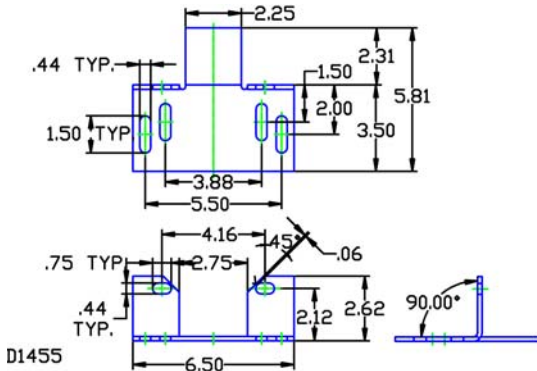

Pump 15 • Iron • C56 Frame • 1750 RPM

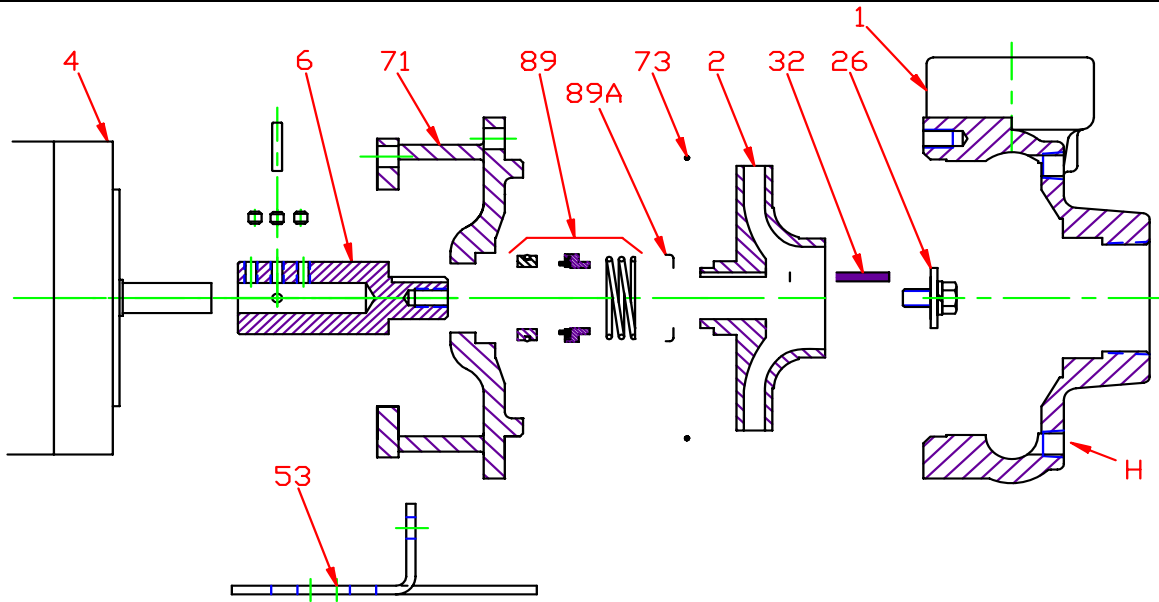

KEY NO.	PART NAME	PUMP NO. 15
1	CASE, IRON, 3 x 3 NPT	130.000.224X
2	IMPELLER, 7/8" KEYED, ENCLOSED, SPECIFY DIAMETER:	
	CIBR	131.000.827
	IRON	137.000.106
	BRONZE	131.000.805
4	MOTOR, C56	See Chart
6+*	STUB SHAFT, BRONZE	135.000.165X
	STUB SHAFT, STAINLESS	135.000.174X
26*	IMPELLER RETAINER, STAINLESS	118.000.111A
32*	KEY, STAINLESS	102.000.102
53	BASE, STEEL	119.000.237A
71	ADAPTER, IRON	132.000.194X
73*	GASKET, CASE, BUNA	116.000.146
89*	1½" SEALS:	
	BN-CARB/CM	101.000.168
	VN-CARB/CM	101.000.191
	VN-CARB/SIL	101.000.175
	VN-SIL/SIL	101.000.204
	EPDM-CARB/SIL	101.000.175B
	EPDM-SIL/SIL	101.000.204A
89A*	SEAL RETAINER, STAINLESS	104.000.175
--	° REPAIR KITS:	
	BN-CARB/CM SEAL	118.000.381
	VN-CARB/CM SEAL (S)	118.000.381A
	VN-CARB/SIL SEAL	118.000.381B
	VN-SIL/SIL SEAL (S)	118.000.381D
	EPDM-CARB/SIL SEAL	118.000.381C
	EPDM-SIL/SIL SEAL	118.000.381E

* DENOTES COMPONENTS INCLUDED IN REPAIR KIT.
 ° ALL REPAIR KITS INCLUDE THE BRONZE STUB SHAFT EXCEPT THE (S) INDICATED, WHICH IS STAINLESS.
 + INCLUDES SET SCREWS AND PIN

Pump 15 • Iron • C56 Frame • 1750 RPM

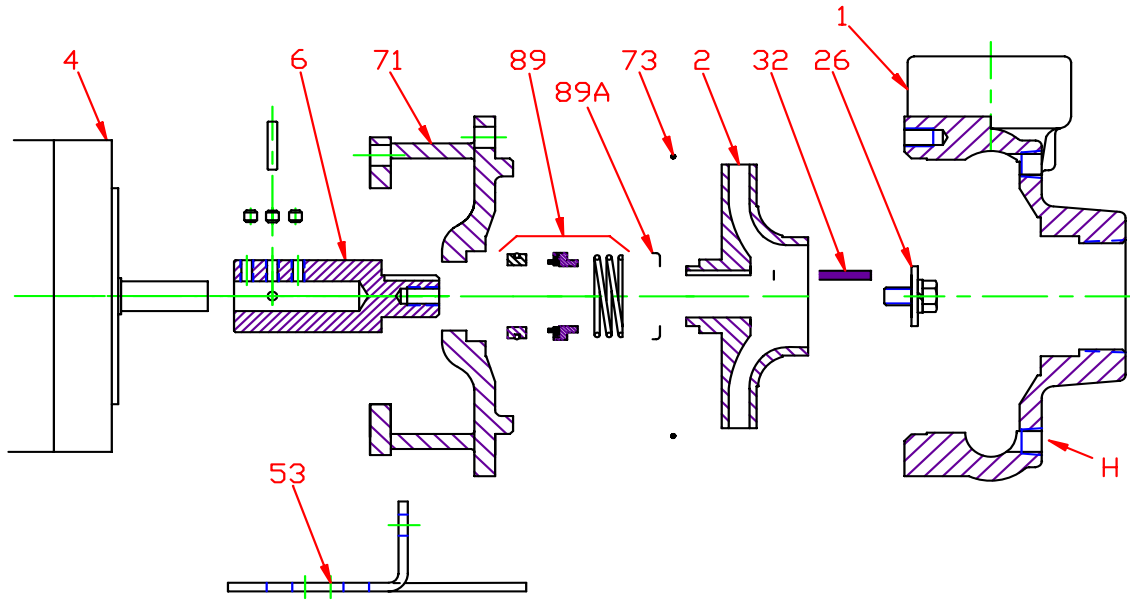

CONSTRUCTION OPTIONS

KEY	PART NAME	STANDARD FITTED	BRONZE FITTED	ALL IRON
1	Case	Iron	Iron	Iron
2	Impeller	CIBR	Bronze	Iron
6	Stub Shaft	Bronze	Bronze	Stainless
26	Imp. Retaining Ass'y	Stainless	Stainless	Stainless
32	Key	Stainless	Stainless	Stainless
53	Base	Steel	Steel	Steel
71	Adapter	Iron	Iron	Iron
73	Gasket, Case	O-Ring BUNA	O-Ring BUNA	O-Ring BUNA
89	Mechanical Seal, Type 21 BN-CARB/CM	Standard	Standard	Standard
89A	Seal Spring Retainer	Stainless	Stainless	Stainless
H	Plug, Drain	Brass	Brass	Plated Steel

CIBR: Cast iron with brass wear ring on eye

E017C56

C11

C0151750C56